

# MEBS6005 Building Automation Systems

<http://ibse.hk/MEBS6005/>



## Fire and Security Systems



*Ir Dr. Sam C. M. Hui*

Department of Mechanical Engineering

The University of Hong Kong

E-mail: [cmhui@hku.hk](mailto:cmhui@hku.hk)

Jan 2024

# Contents



- Basic principles
- Security systems
- CCTV systems
- Access control systems
- Burglar & intruder alarms



# Functions of building automation system (BAS)

## Fire & security

### FIRE

Functionality checks  
Detector service  
Fire, Life, Safety

### SECURITY

Doors  
PIR  
Integration

### ACCESS

Doors  
Buildings  
Occupancy  
Feed Forward

### ENERGY

Utility Monitoring  
(Elec/Water/Gas/Oil)  
Tenant Building  
Air/Water  
Heat  
Lighting  
Back-up Generation

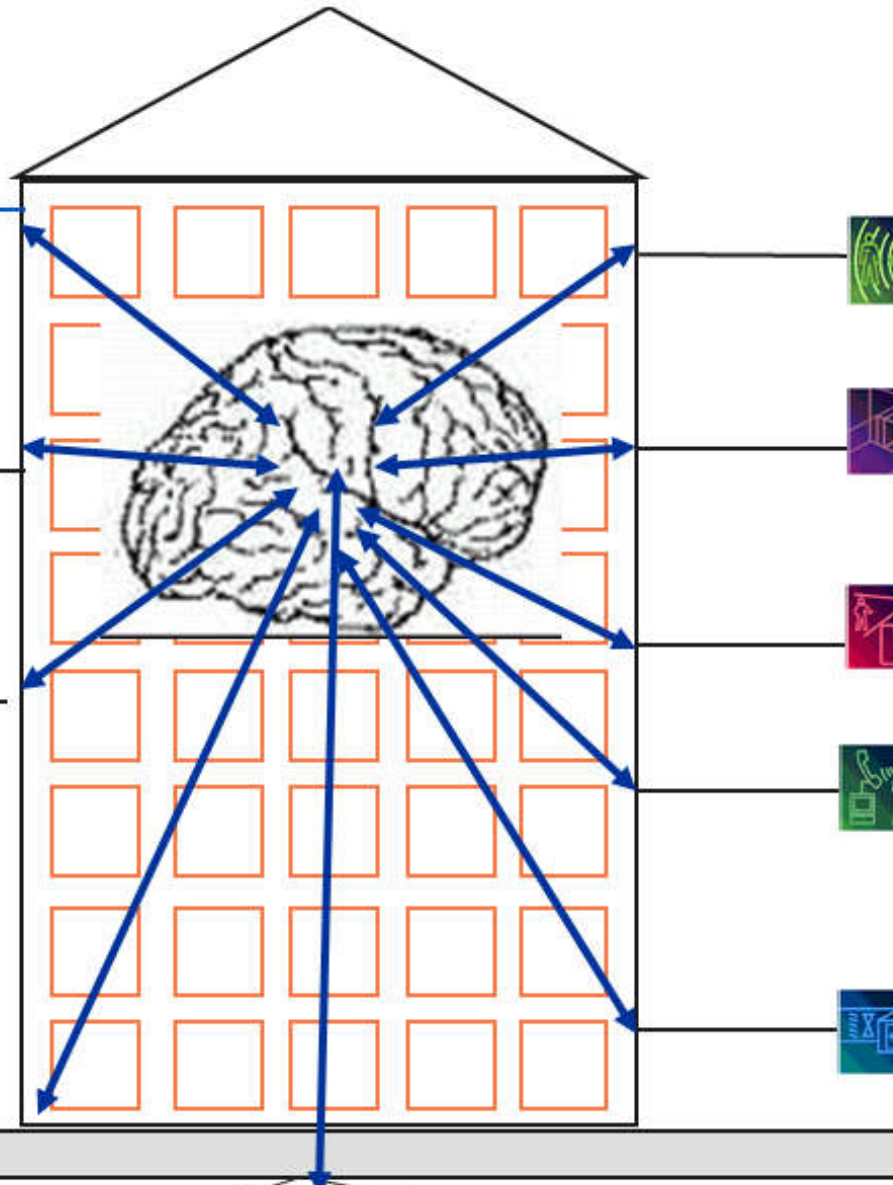

### LIGHTING

Schedules  
Occupancy Sensing

### PEOPLE MOVERS

Breakdown  
Maintenance  
Traffic Performance

### COMMUNICATIONS

Voice/Video/Data

### 24/7 Monitoring

Breakdown  
Plant Tuning  
Conditioned Monitoring  
Car Park Utilisation

### HVAC

Air-Handling Unit  
Boilers  
Pumps  
Fans  
Energy Control  
Variable Air Volume  
Air Quality



# Fire, security & other extra low voltage (ELV) systems in commercial buildings





# Basic principles

- BAS can control all aspects of a building, including fire alarm & security systems
- Traditional mind-set: (fear of unknown risk)
  - BAS & fire alarm systems should maintain a significant level of separation with minimal connectivity or interaction
- New thinking: (advent of smart building)
  - Integration of BAS & fire alarm systems can result in overall efficiency in operation & reliability

# Addressable fire alarm system

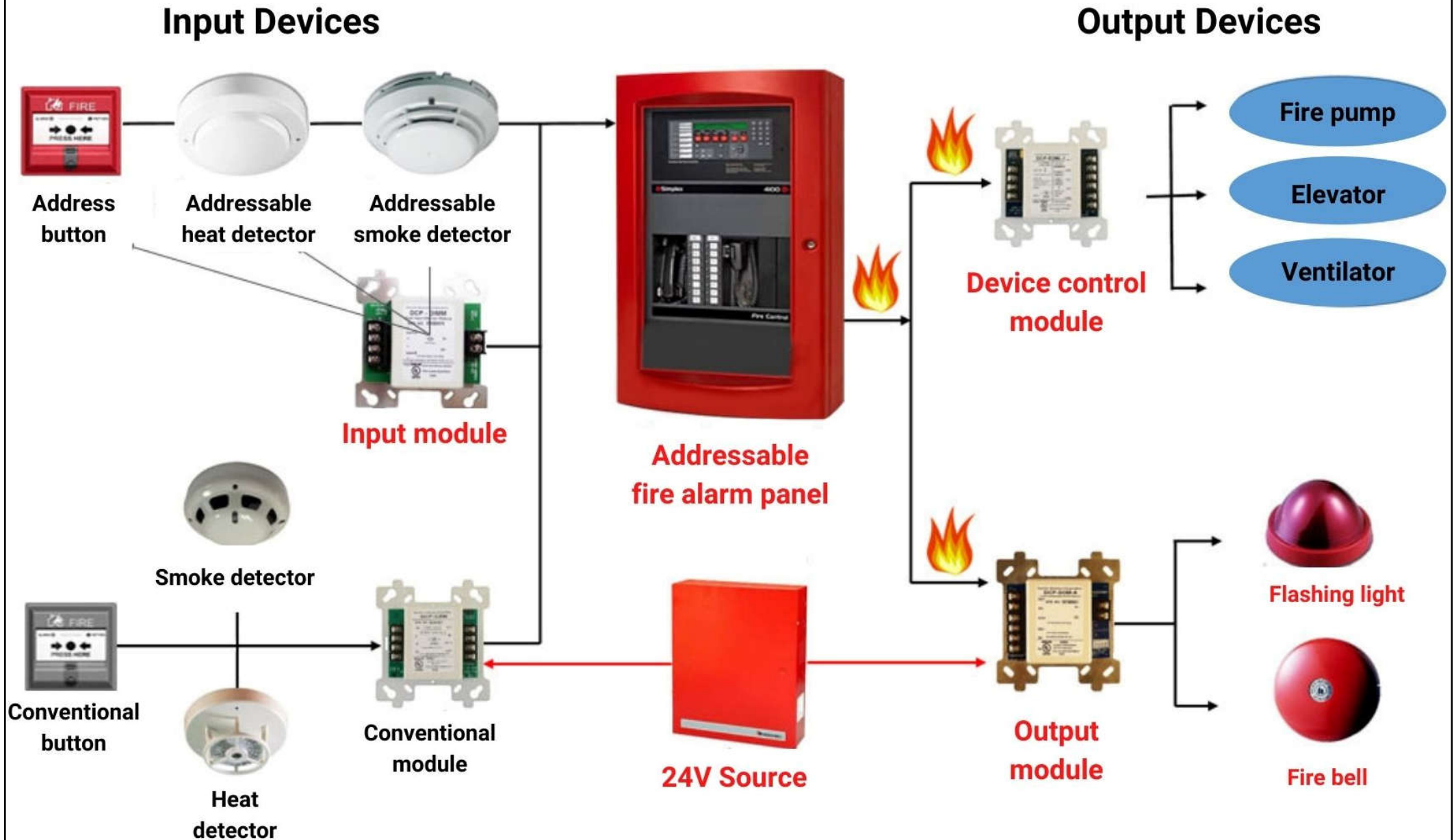

# Components of a basic fire-alarm system

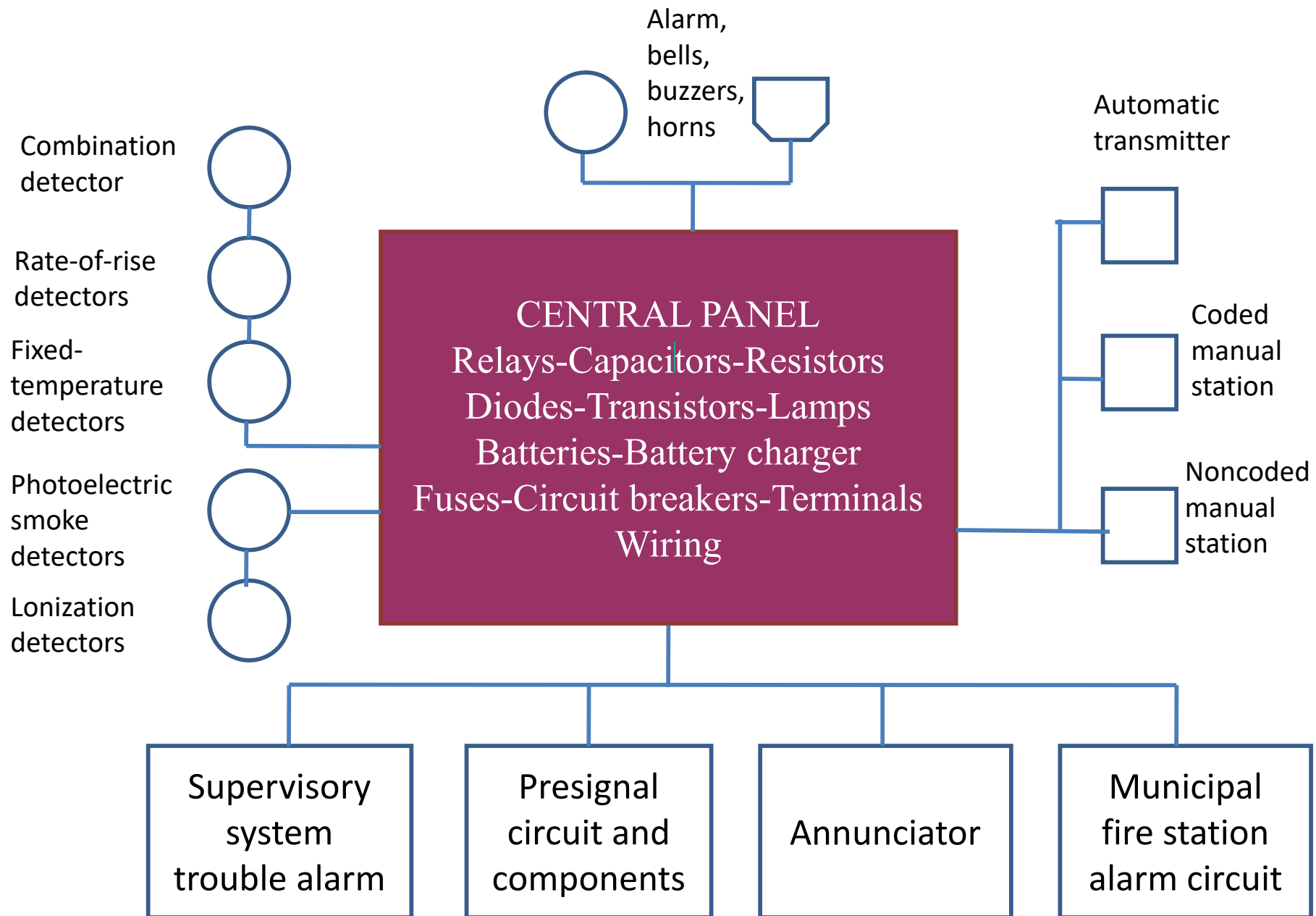

# Schematic diagram of a fire-alarm main control panel

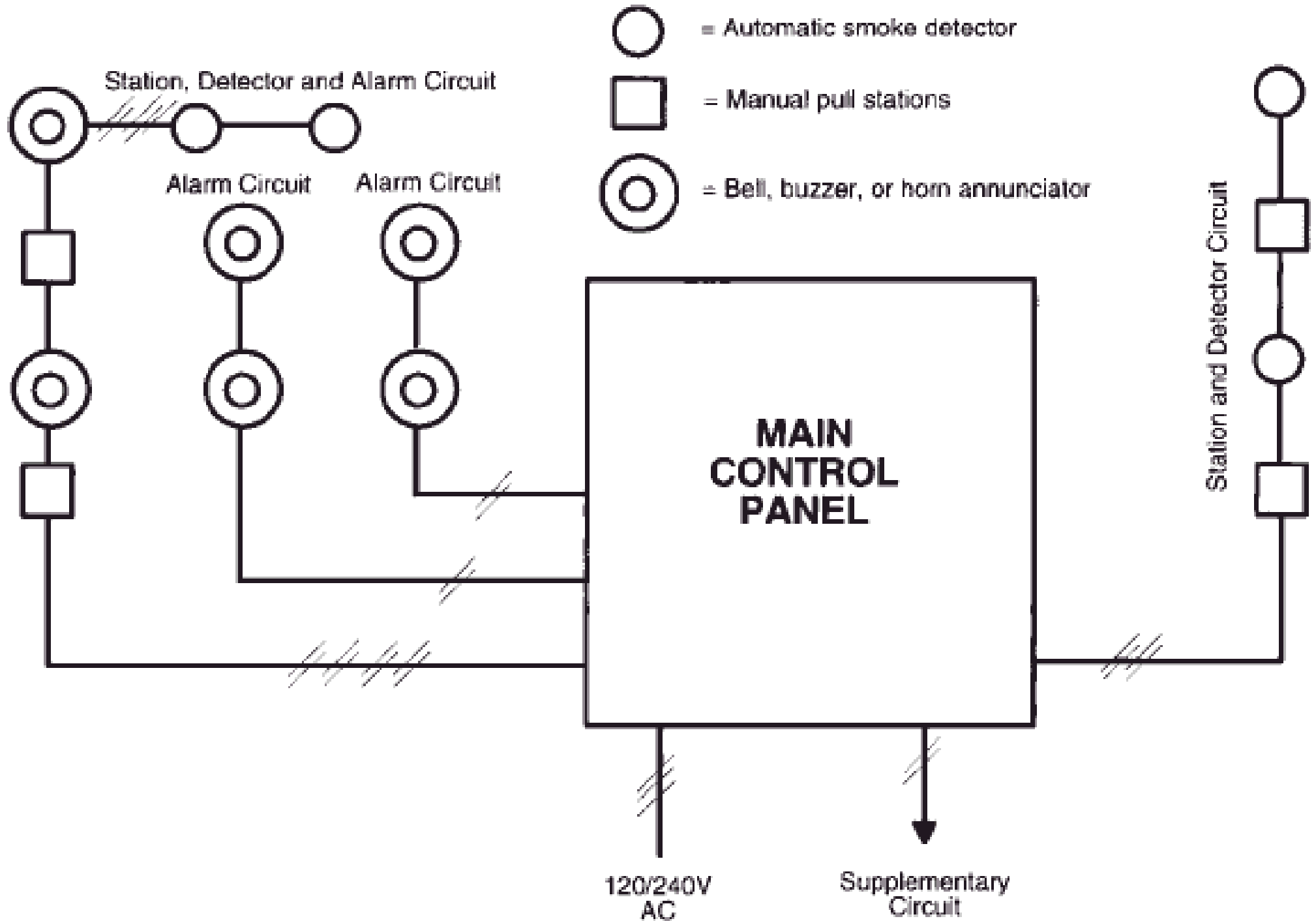





# Basic principles

- BAS are sometimes linked to fire alarm systems, access control, other security systems & elevator/lift control for monitoring
  - In case a fire is detected then only the fire alarm panel could close dampers in the ventilation system to stop smoke spreading, shut down air handlers, start smoke evacuation fans, and send all the elevators to the ground floor & park them to prevent people from using them

# Example of an integrated building management system

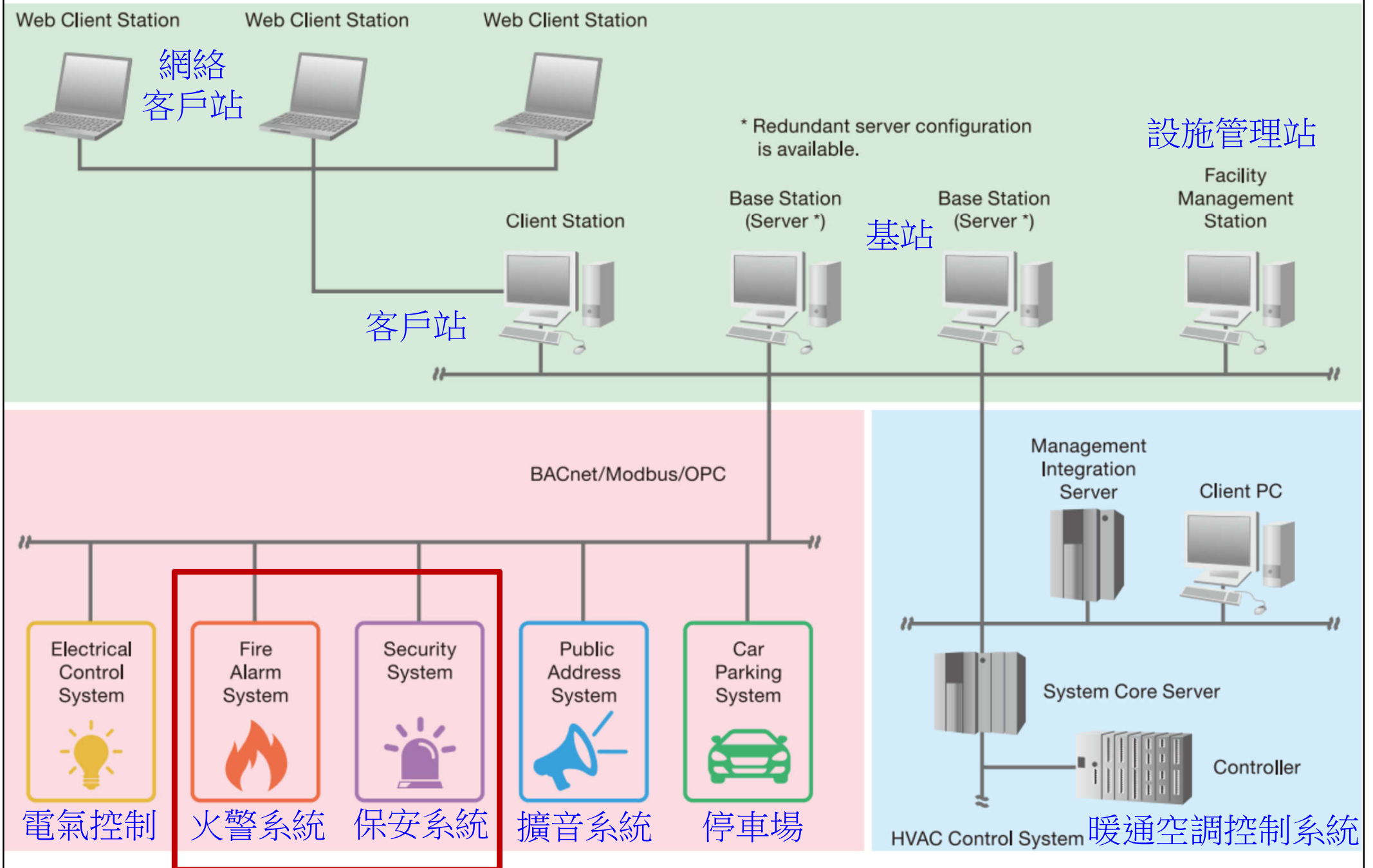

# Integrated solution for fire safety, security & BAS/BMS

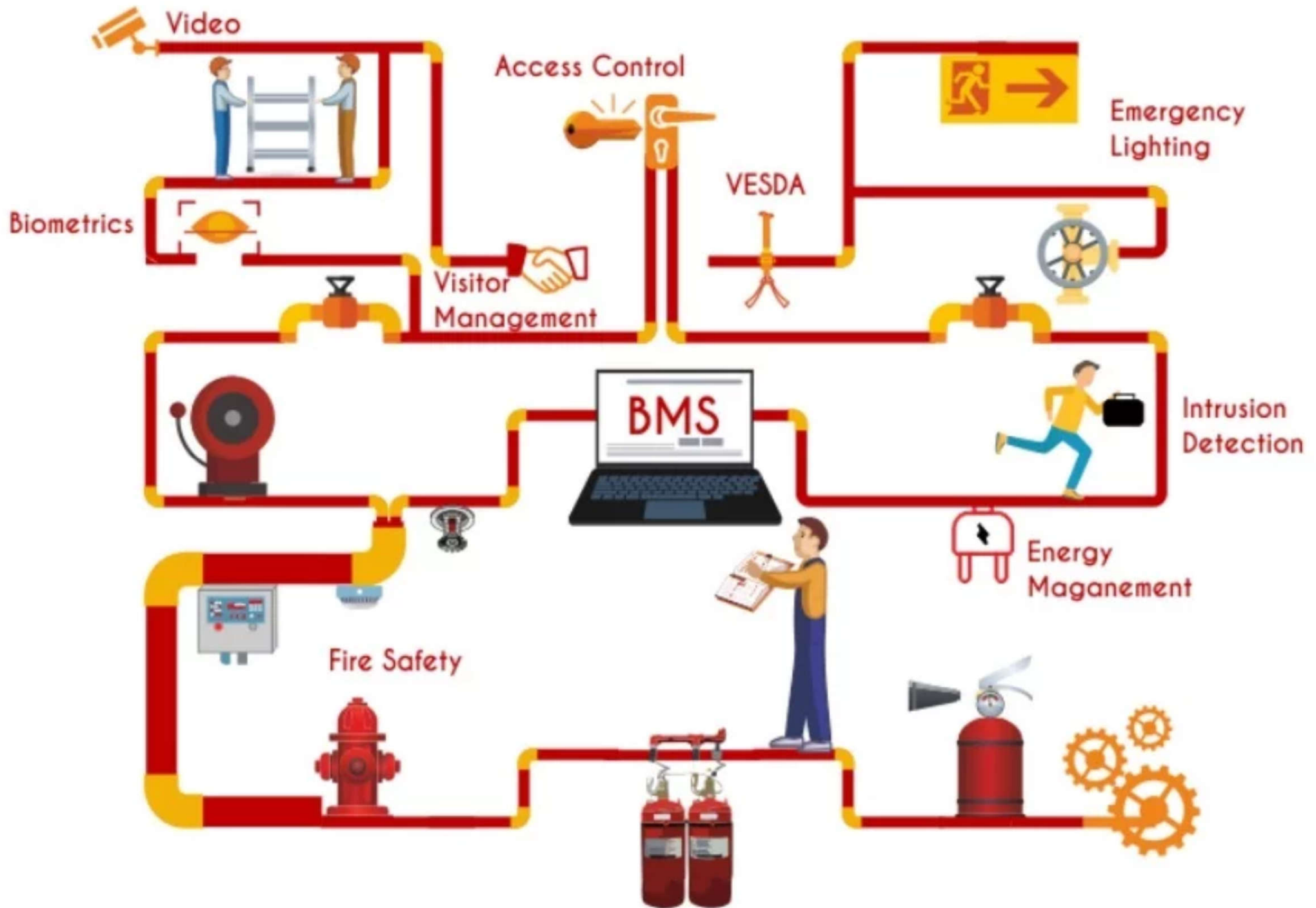



# Basic principles

- BAS functionality in emergency situations
  - Power failures
    - A good BAS can review & restore the operation of fans, motors, pumps, chillers, and other points in sequence in order to prevent power surges
  - Fire/life safety
    - Alarms & voice commands
    - Smoke control & HVAC
    - Control of elevators/lifts
    - Firefighter control & communication





# Basic principles

- BAS can provide real-time monitoring & alerts for fire & security issues, integrate with emergency response systems, etc.
  - For example, smoke control systems require the marriage of mechanical fan systems with fire protection/fire alarm systems
    - There is a certain level of priority and sequences that must be followed
    - If a smoke control fan operates before dampers open, ductwork may be damaged or door opening forces may be increased beyond acceptable levels for egress

# Integration of BAS & fire alarm systems

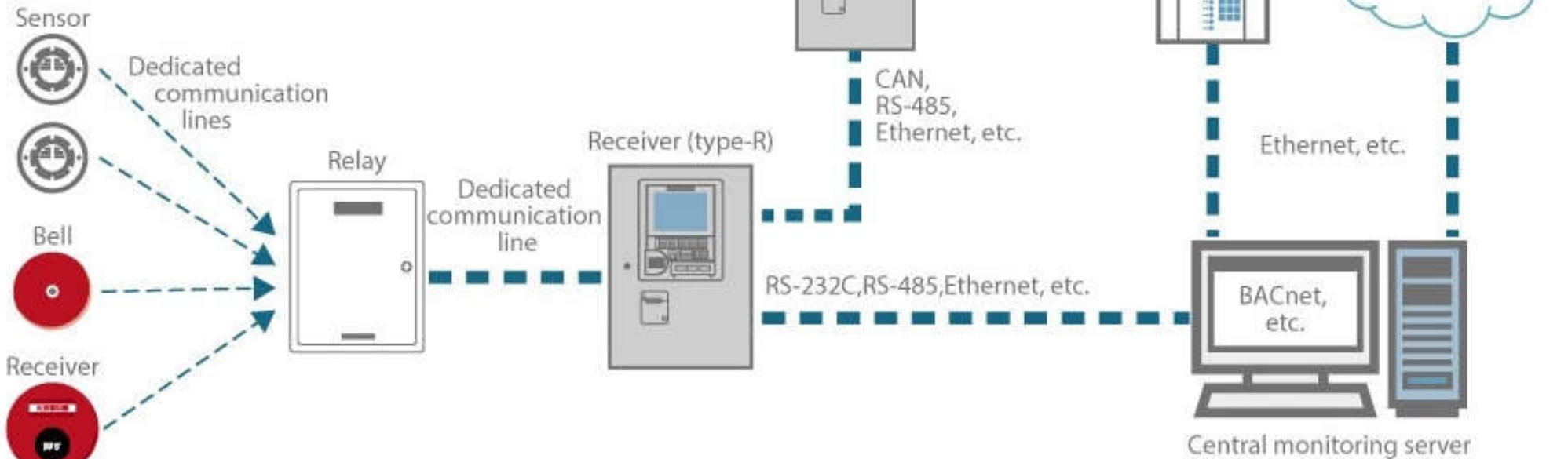
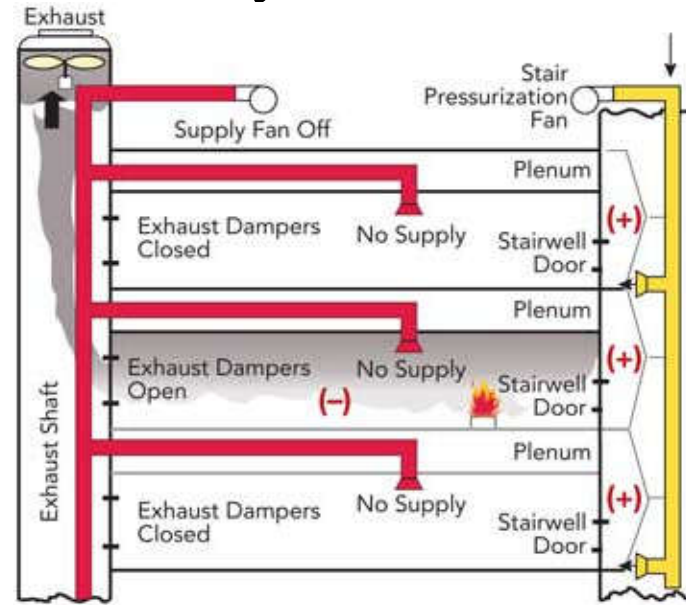
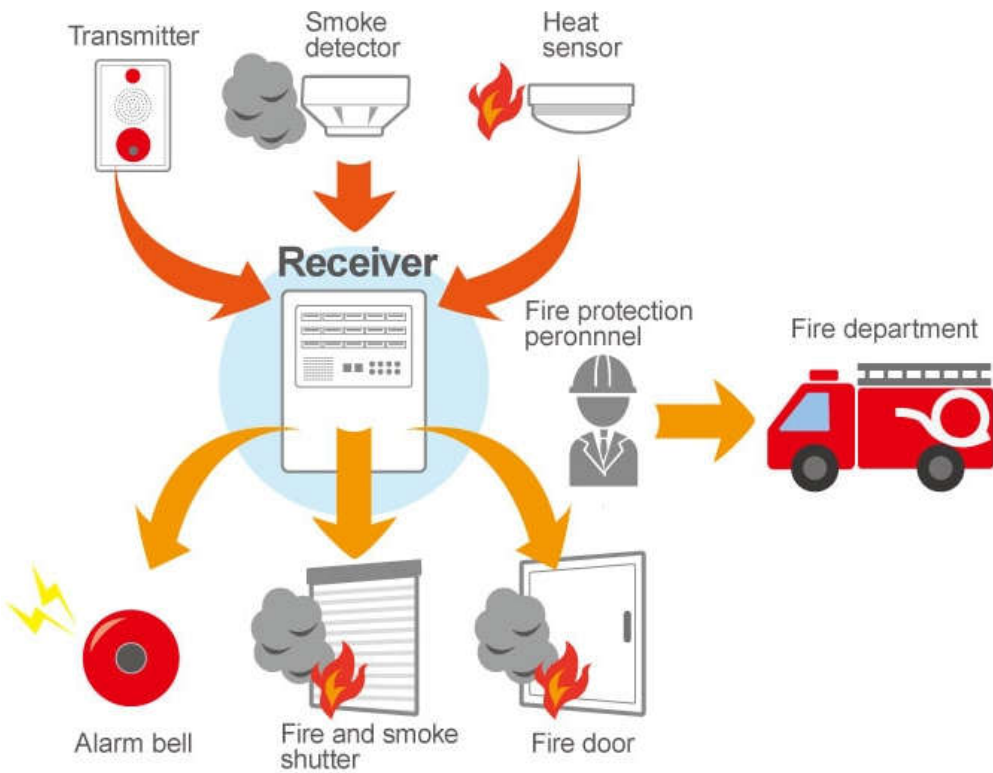

# Basic principles



- BAS & fire alarm systems
  - Fire alarm products now often have a BAS gateway
    - Allows monitoring but little/no control
    - Manufacturers of both fire alarm & BAS can have bidirectional communication
    - Most fire alarm systems today have the capability to output fire alarm signals over BAS protocols
  - Use sensor data to estimate fire conditions
    - Non-fire signaling system
    - To ensure life safety is not impacted by any non-fire system, a listed barrier gateway must be provided to prevent other systems from interfering with or controlling the fire alarm system



Real-time  
evacuation  
guidance

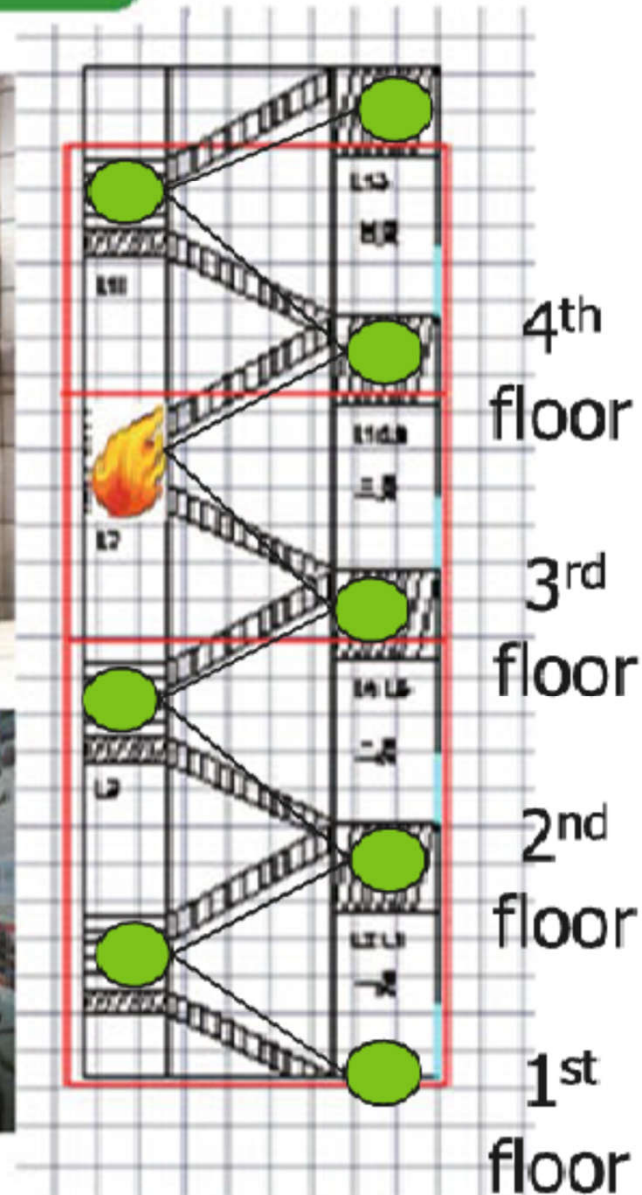
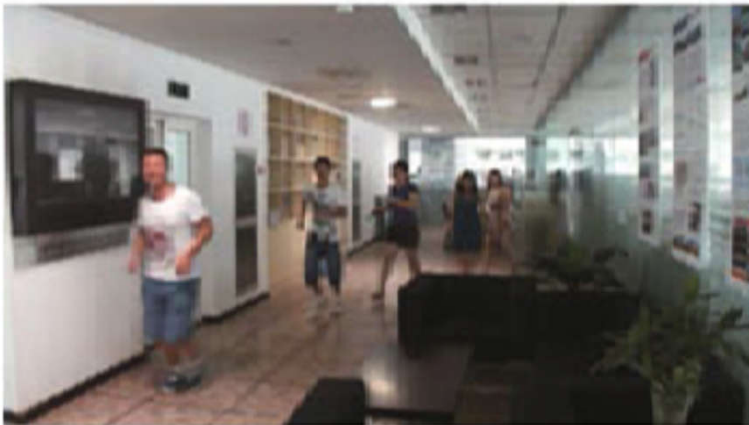



# Security systems



- Security systems are indispensable to any type of building. They provide consistency in business operations and keep tangible assets, intellectual property & people safe
  - Each type of property is vulnerable to different hazards and requires a unique set of safety & security measures
  - Some common building security threats: unauthorized access, fire, accidents, or other situations that pose a hazard to human life

# Common security & alarm systems

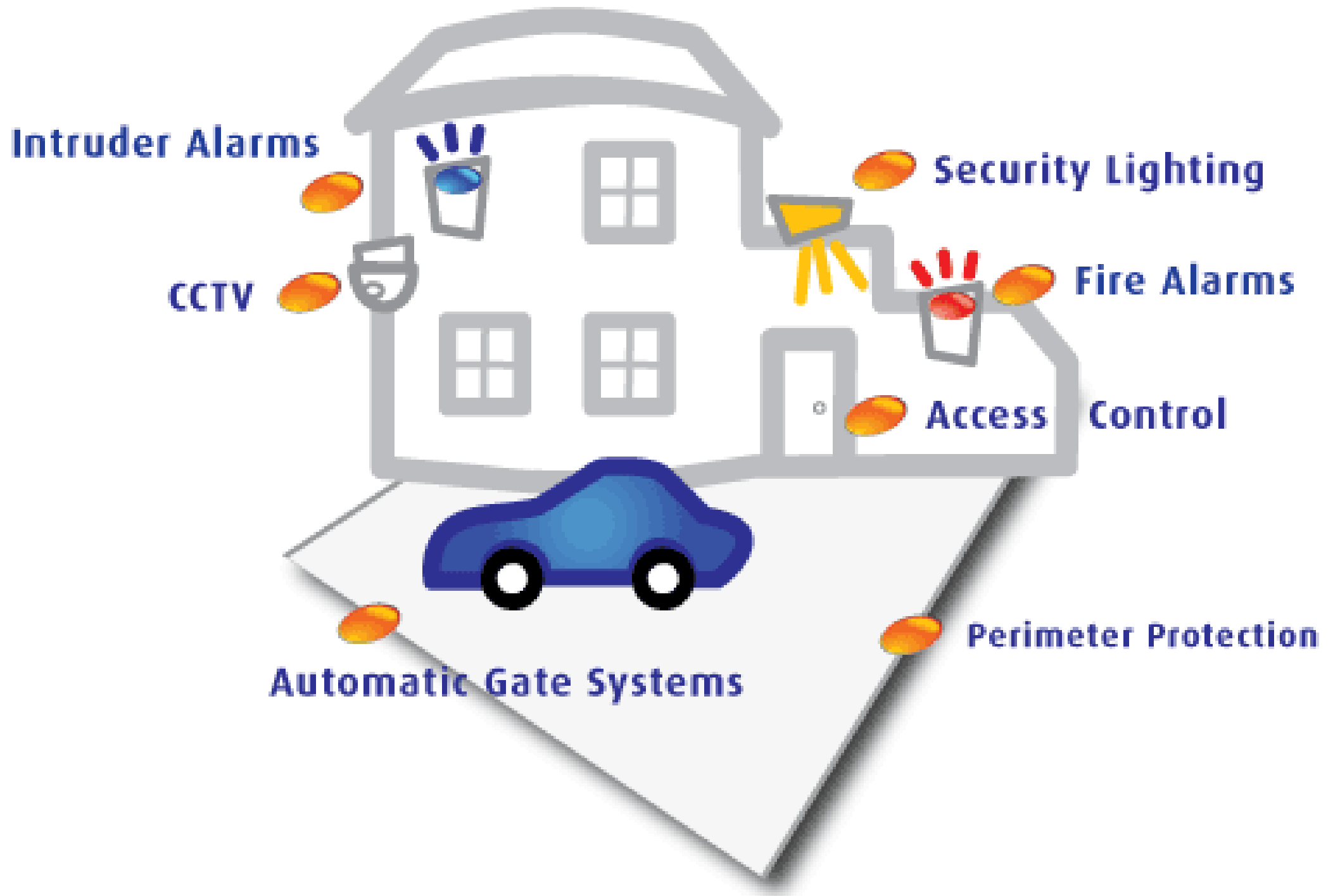

# Security systems in commercial buildings

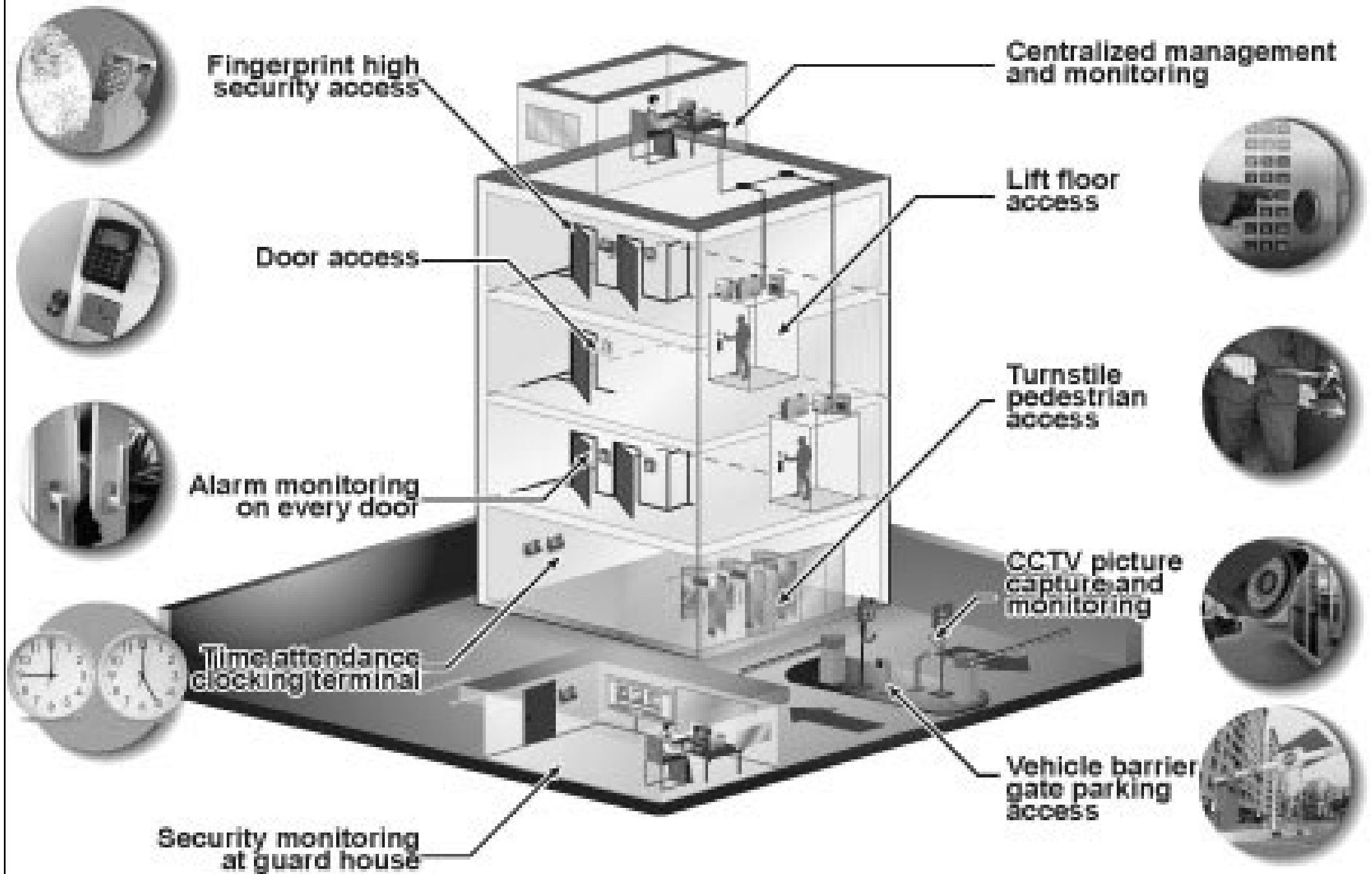

# Security systems



- Common types of security systems:
  - Burglar alarm system (central or local)
  - Closed circuit television (CCTV) surveillance
  - Intruder detection & access control
  - Intercom systems (audio/video)
  - Door-phone system & interlocking system
  - Panic attack (PA) button & sound system
  - Security lighting
  - Guard tour/monitoring system



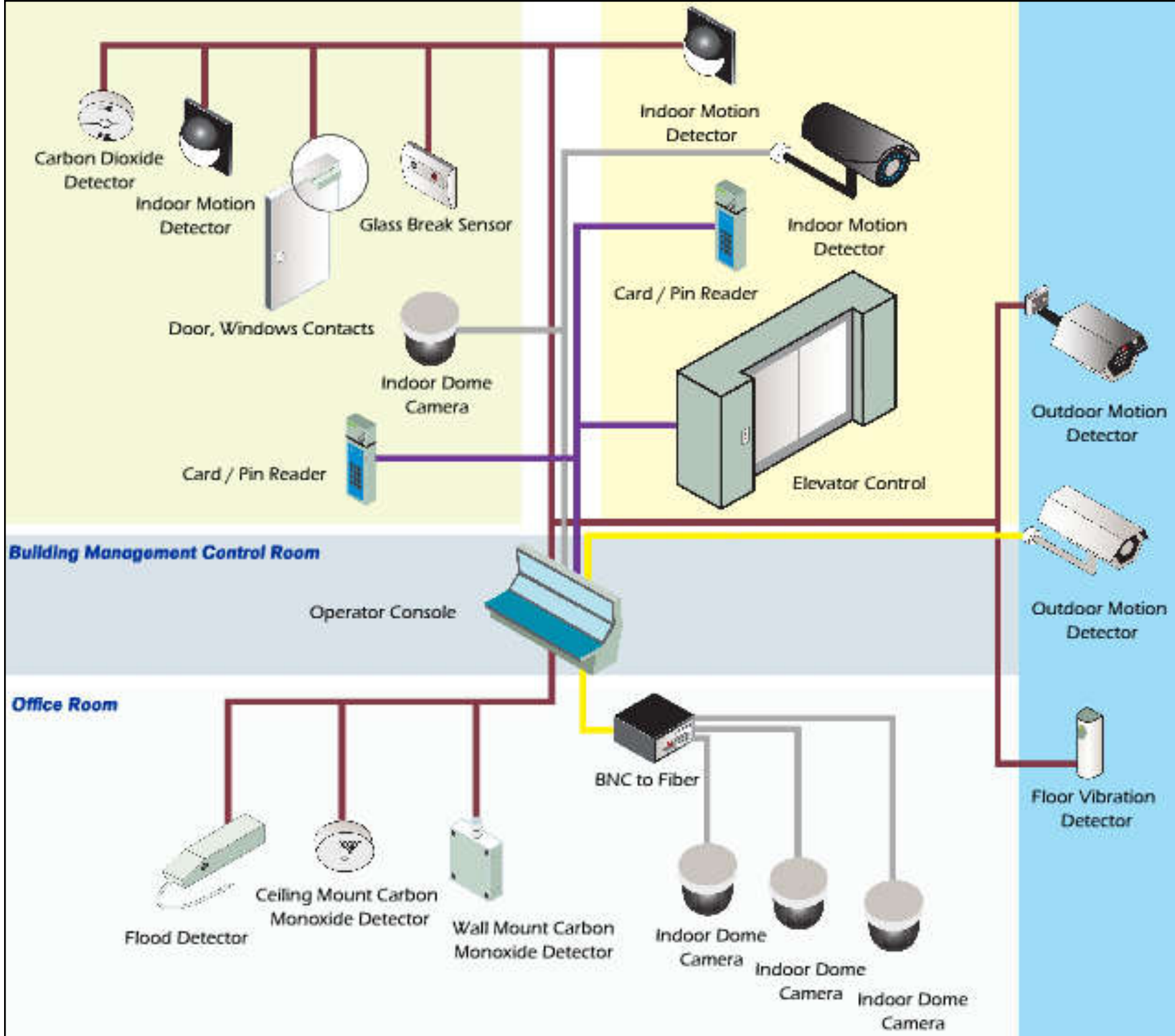

Examples of extra low voltage (ELV) security systems & devices in buildings

# Sensors & components of security & building management systems



(Source: <https://damiaglobalservices.com/building-energy-management-system/>)

# Crime prevention & monitoring functions of security systems







# Security control room for a large building complex



# Integrated security in a typical building management solution

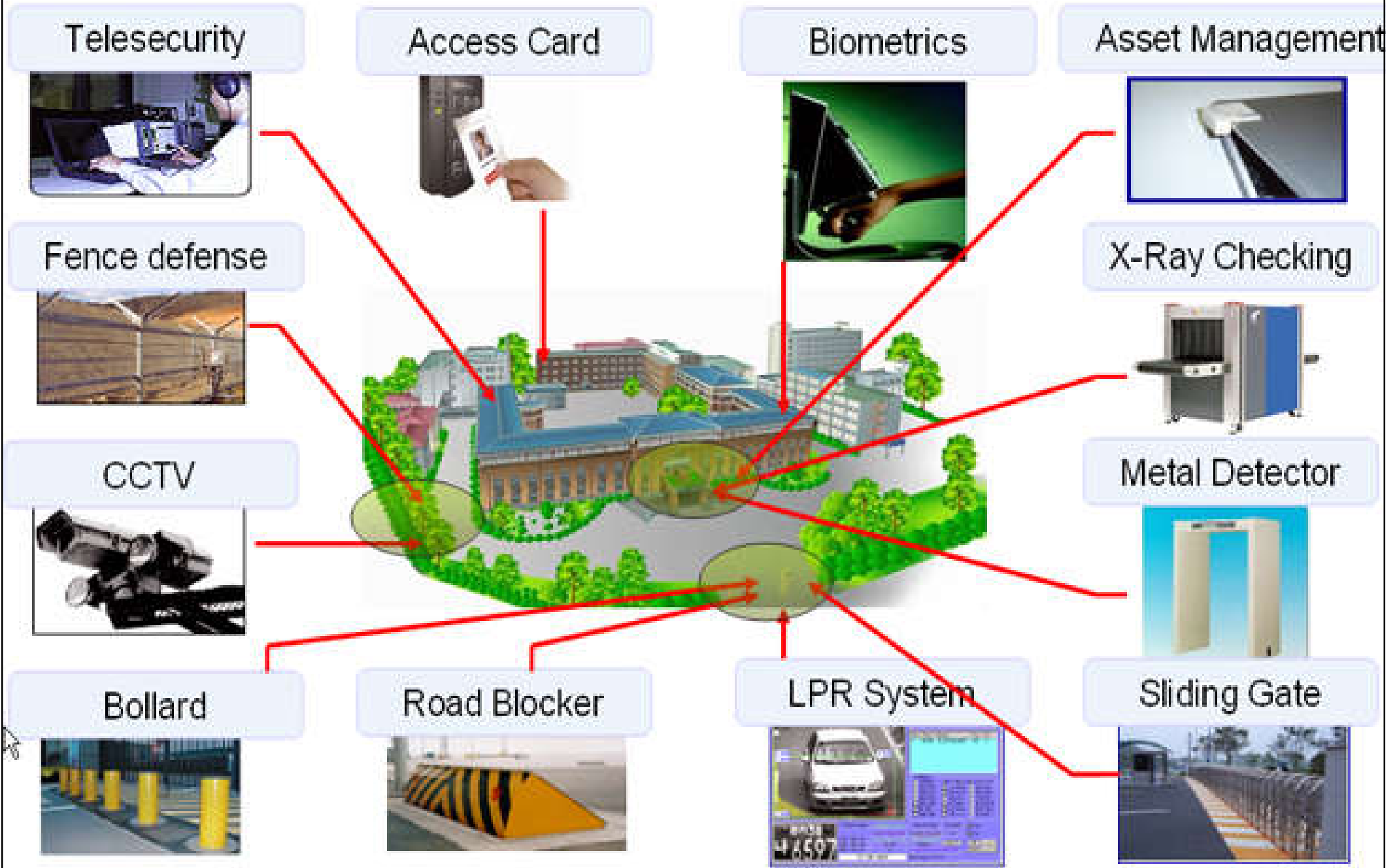

# Example of burglary & fire alarm with integrated functions in BAS

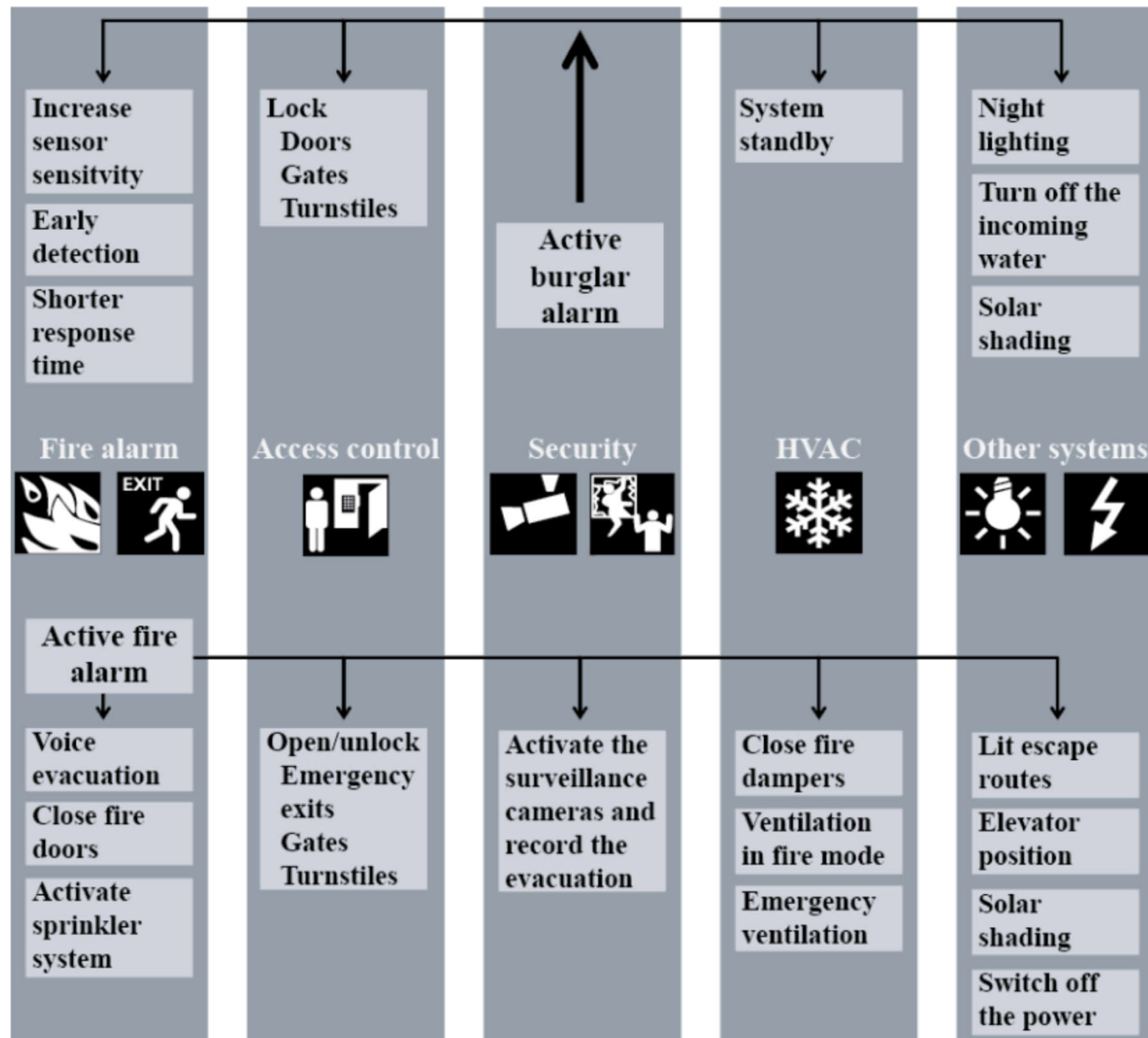

# CCTV systems



- Closed circuit television (CCTV) system 閉路電視

- Functions

- 24 hour surveillance/deterrence
- Real time or time lapse recording (on a closed loop basis)
- Motion/alarm activated monitoring & recording
- Area search using remotely controlled cameras

- Integration with access control & other security systems

- Components (now mainly digital)

- Video camera (colour or monochrome)
- Monitors, recorders and switchers
- Multiplexer (triplex operation simultaneous playback & recording)

- Key factors: quality, storage, export, playback



# Different types of CCTV cameras



Types of cameras:-

- Dome camera
- Bullet camera
- Fisheye camera
- C-Mount camera
- Pan-tilt-zoom (PTZ) camera
- Day/Night camera
- Thermal camera
- Infrared/Night vision camera
- Network/IP camera
- Wireless camera
- High-definition HD camera

# Basic concept of a multi-camera CCTV system

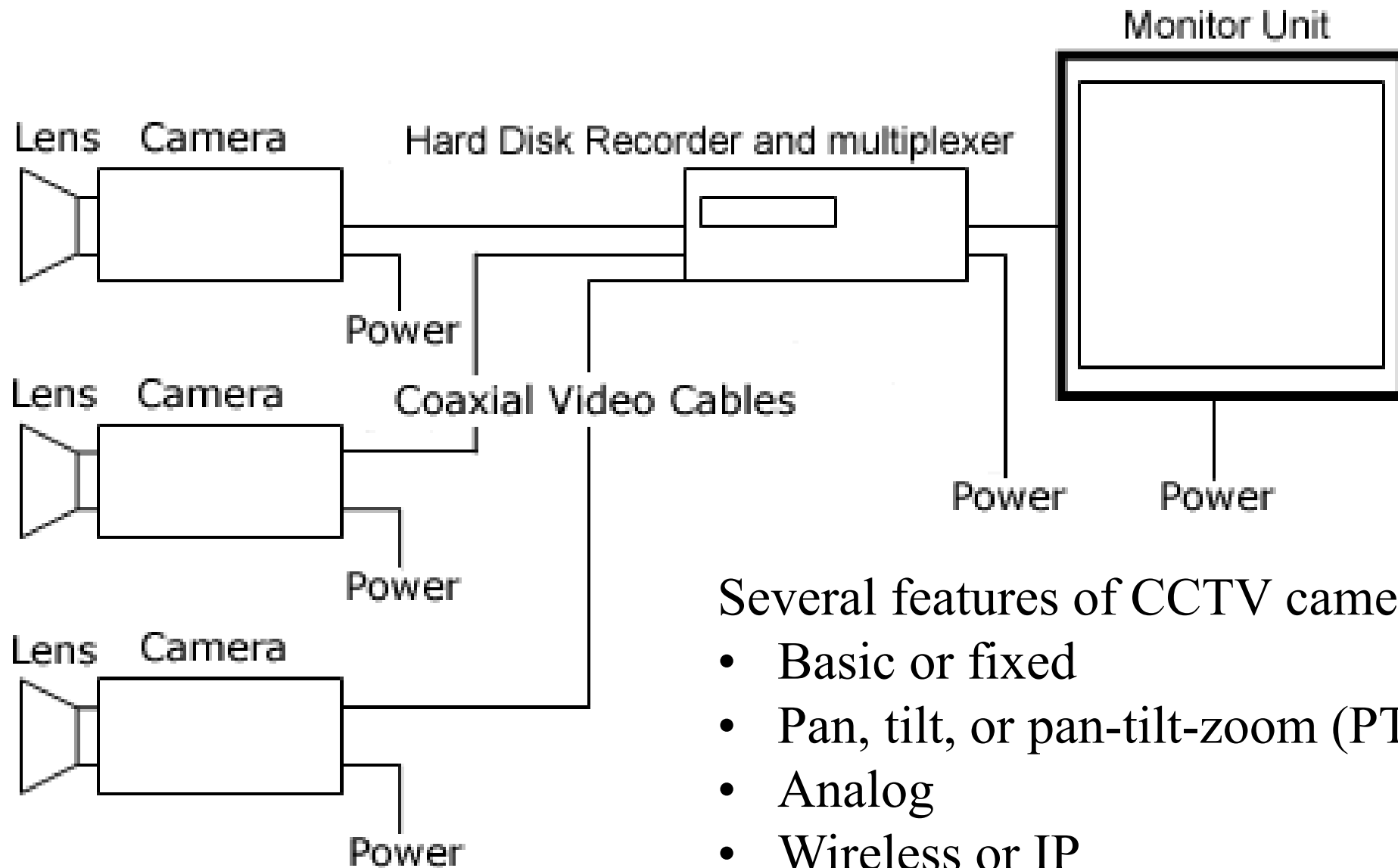

Several features of CCTV cameras:

- Basic or fixed
- Pan, tilt, or pan-tilt-zoom (PTZ)
- Analog
- Wireless or IP
- Night vision
- Exterior
- Motion-detection



# CCTV systems

- Uses of CCTV systems:
  - Crime prevention (and deterring)
  - Crime investigation (a forensic tool)
  - Vehicle traffic monitoring (e.g. in car parks)
  - Pedestrian traffic (crowded) monitoring
  - Allow drivers to confirm people are clear of doors
  - Monitor access to secure or private areas
  - Employee/staff monitoring
  - Video surveillance in schools, shops or homes

# The resolution makes a big difference – comparing CCTV cameras







# CCTV systems

- Technological advances of CCTV systems:
  - Video at full-colour & high-definition
  - Compression & storage of recordings
  - Save to the cloud via wired or Wifi network
  - Video content analysis (e.g. artificial intelligence)
    - Facial & image recognition, behaviours (suspicious or violent activities)
  - Internet protocol (IP) cameras
  - Wireless & networking security cameras
  - Talking CCTV (by the operator)

CCTV smart  
cameras for  
image  
recognition

# Behavioral recognition by using CCTV video content analysis

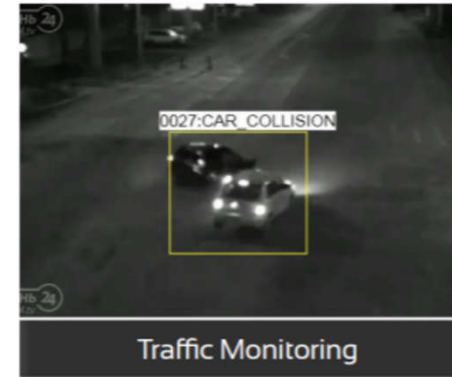

## Violent Activity

- People fighting
- Brawl/Riot
- Vandalism
- Person with blood
- Person with weapon

## Suspicious Activity

- Contextual loitering, tailgating
- Person abandons an object
- Person with mask /no mask
- Person running/walking/falling
- Person gets in/out of a vehicle

## Person & Crowd Behaviour

- Crowd classification by size
- Crowd moving /gathering /dispersing
- Occupancy analytics
- Person to person proximity

## Perimeter Protection

- Person entering/exiting predefined zone
- Vehicle entering/exiting predefined zone

## Traffic Monitoring

- Vehicle counting & classification
- Vehicle behaviour
- Accidents & hazards recognition
- Urban mobility (vehicle+person)
- Traffic congestion

## Environment+Personal Safety

- Smoke/Fire
- Person with/without safety equipment
- Person/Equipment in hazard
- Person falling/on the ground



Video: Understanding for security and surveillance (3:04)

<https://www.viisights.com/products/wise/>

(Source: <https://www.viisights.com/>)

# Internet-based CCTV systems

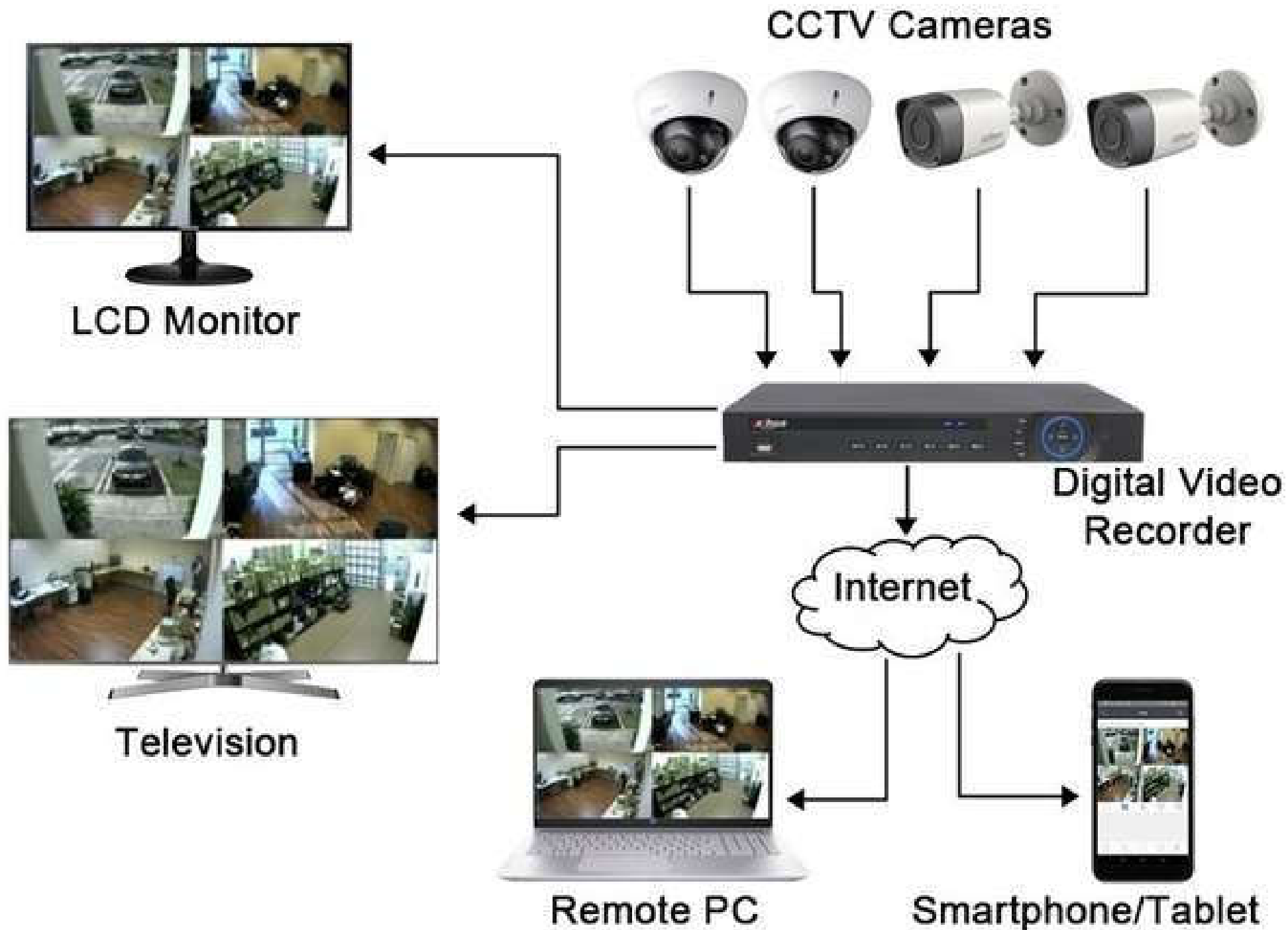



# CCTV systems

- Internet protocol (IP) cameras
  - Connect to the network rather than to a digital video recorder (DVR) using a coax cable
  - The IP camera system includes not only the cameras but also the video recording system
  - Network infrastructure
  - Power over Ethernet (PoE): enough power to support IP devices
  - Video management & recording system
  - Network video recorders (NVR)



# IP camera system diagram

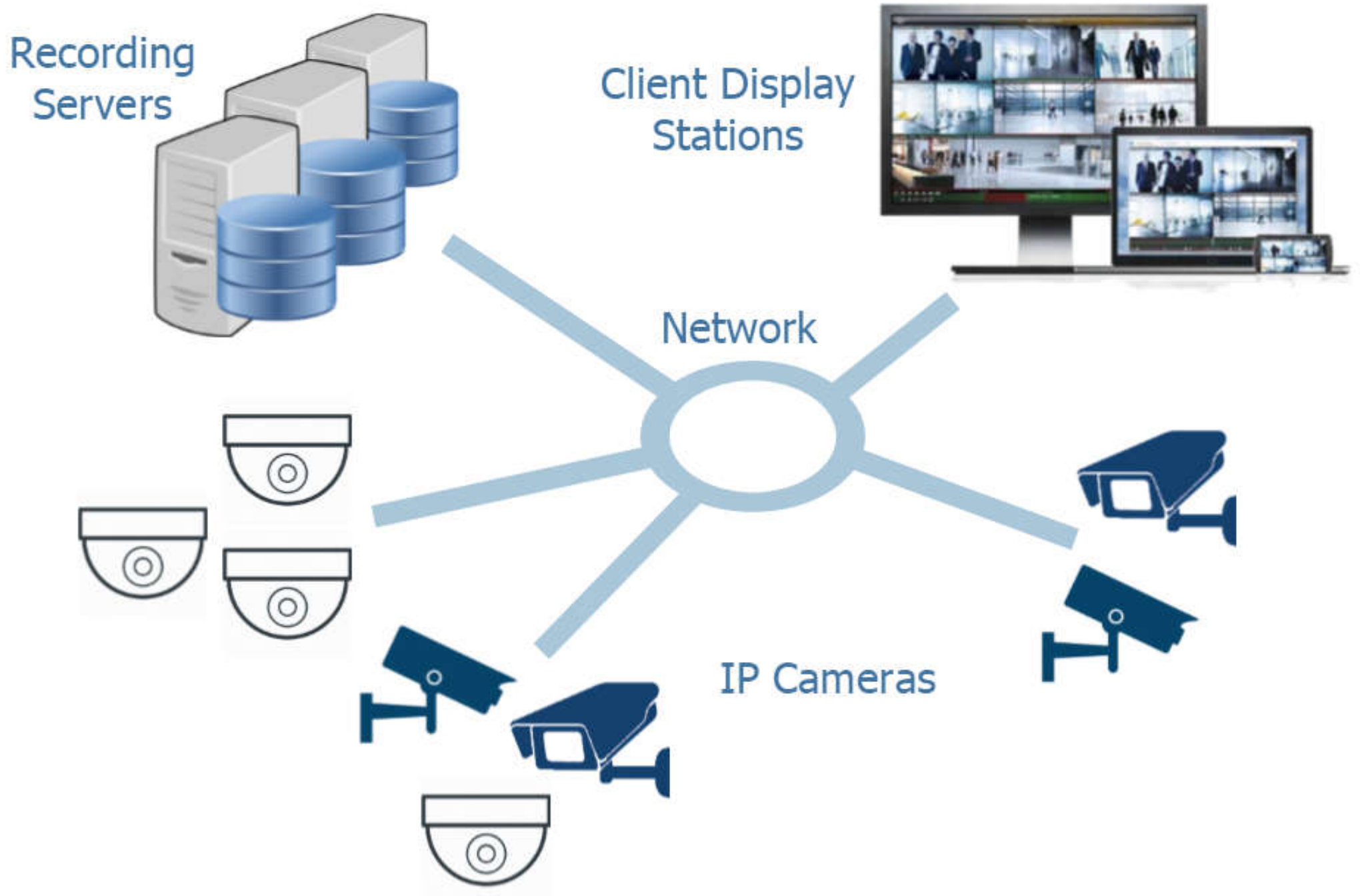

# Examples of CCTV installations with wireless, IP & analogue cameras

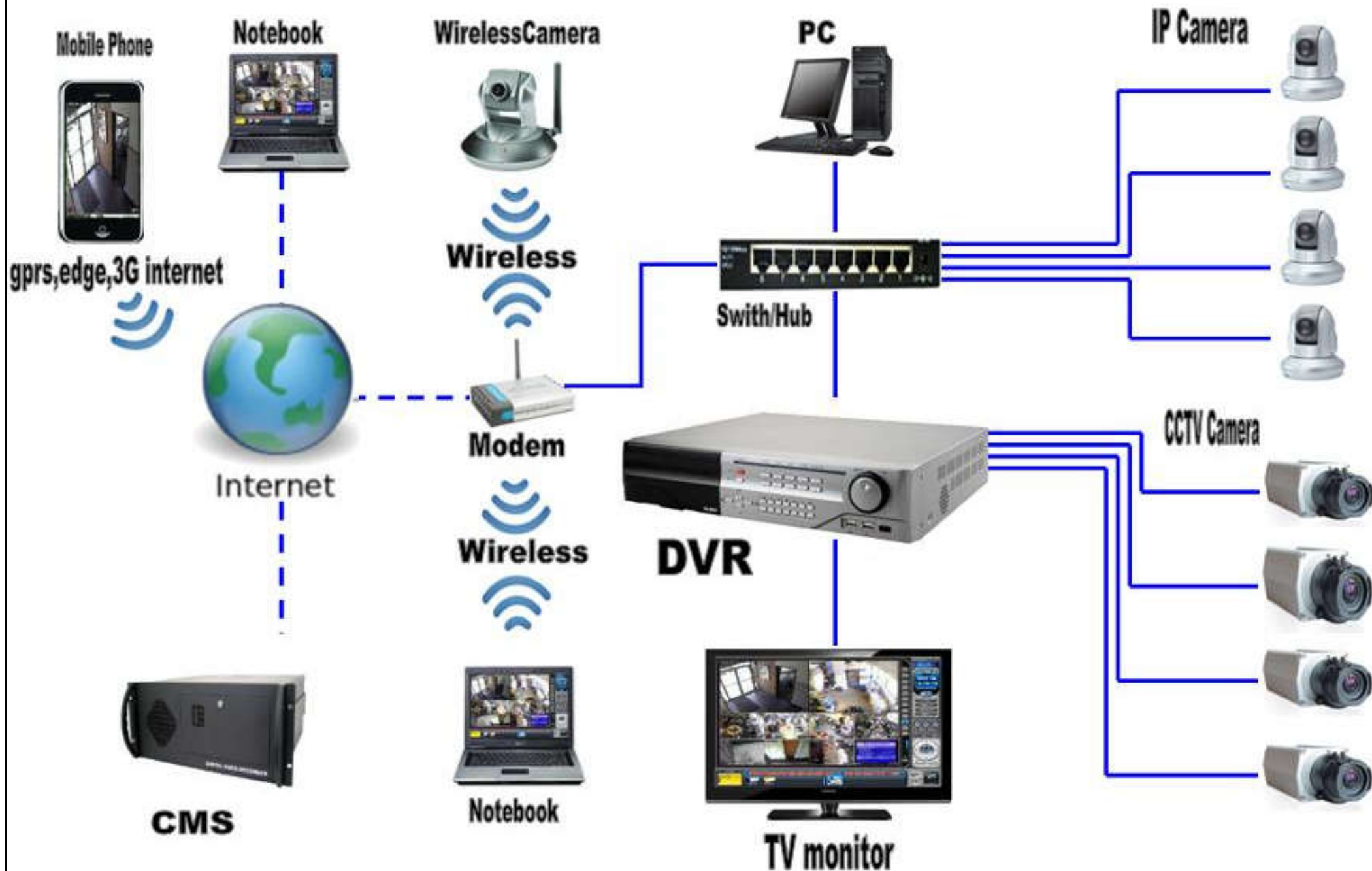

Talking CCTV - the system's operator can challenge criminals or members of the public via an intercom system (help stop antisocial behaviour)





# CCTV systems

- Security cameras as sensors for smart BAS
  - Use digital image processing & analytics to process & analyze data on-site, e.g.
    - Face recognition at entrances
    - Crowd management & counting the number of people
    - Object tracking to prevent theft & vandalism
    - Recognition of vehicle license plates
    - Perimeter detection to help trigger alarms when unauthorised individuals try to gain access into the building & surrounding environment
    - Object detection & identification



# Features of CCTV camera to support smart building automation



# CCTV systems



- Integrate CCTV with smart cameras into BAS
  - Provides the opportunity to react to critical events (security, safety or water ingress)
  - Provide relevant video data & most important concurrently initiating appropriate actions (e.g., smoke extraction in case of fire)
  - Detect the presence of people which act as additional input parameter for the HVAC control (sensor fusion & sharing)
  - Video analytics & intelligence



# BACnet-based camera structure & smart video surveillance

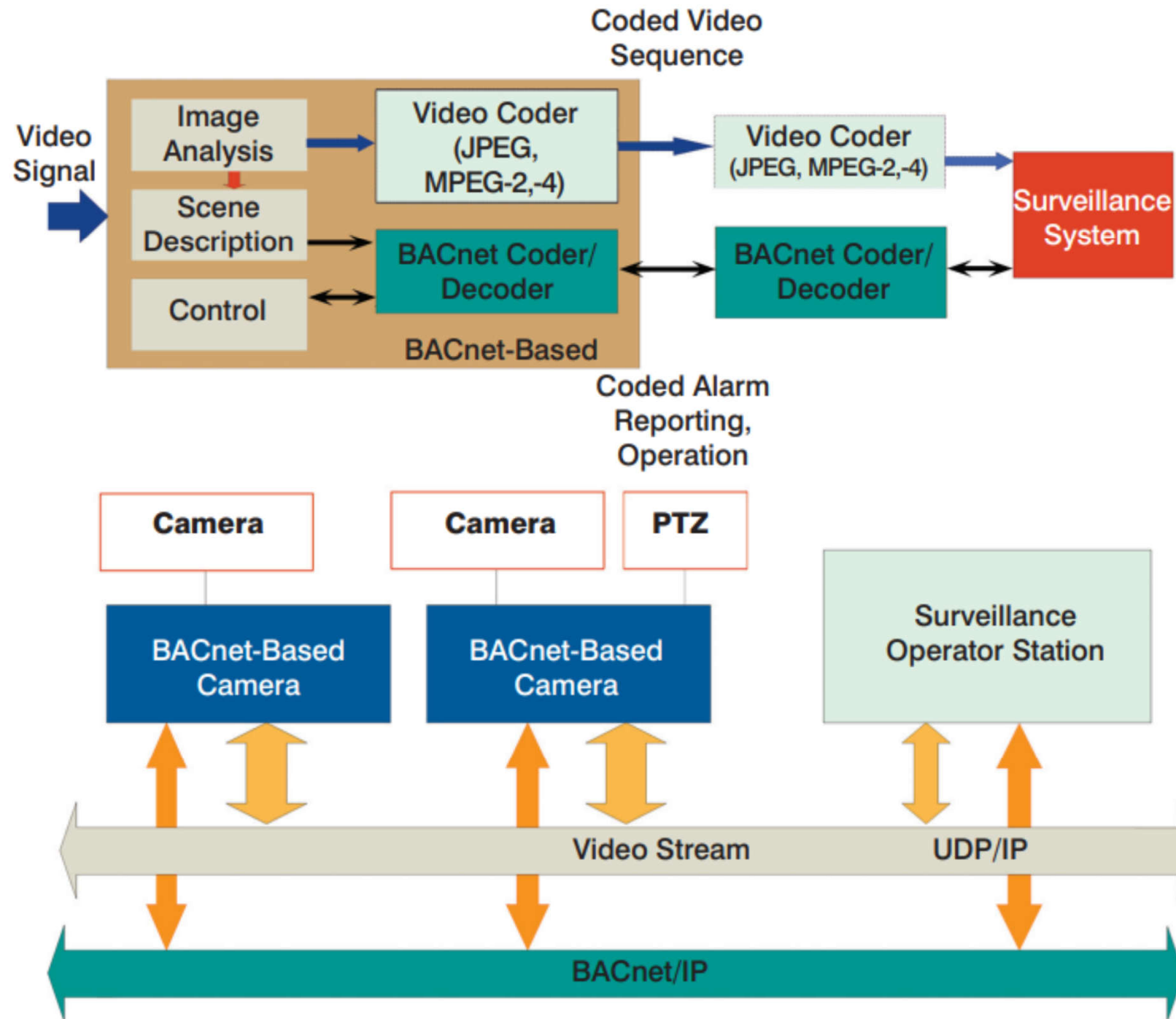



# CCTV systems

- BACnet-based camera integrated with BAS
  - 1. Image analysis
    - Extract the content-based description at the camera
  - 2. Scene description
    - Allows more flexibility in the design of complex & powerful surveillance + greater interoperability
  - 3. Control
    - Pan, tilt, zoom (PTZ), focus, automatic scanning, etc.
  - 4. BACnet coder/decoder (CODEC)
    - Video coder is required to transmit digital video data

# Access control systems



- Access control
  - Stand-alone or online systems
  - Methods:
    - Digital codes
    - Magnetic stripe cards
    - Embedded wire cards
    - Proximity cards/tags
    - Biometric access control (e.g. retina, finger prints)
  - Pedestrian turnstiles (like in subway stations)
  - Car park control (e.g. car park ticket validation)



Access Control Terminal



# Integrated Photo ID Badge and Access Control System

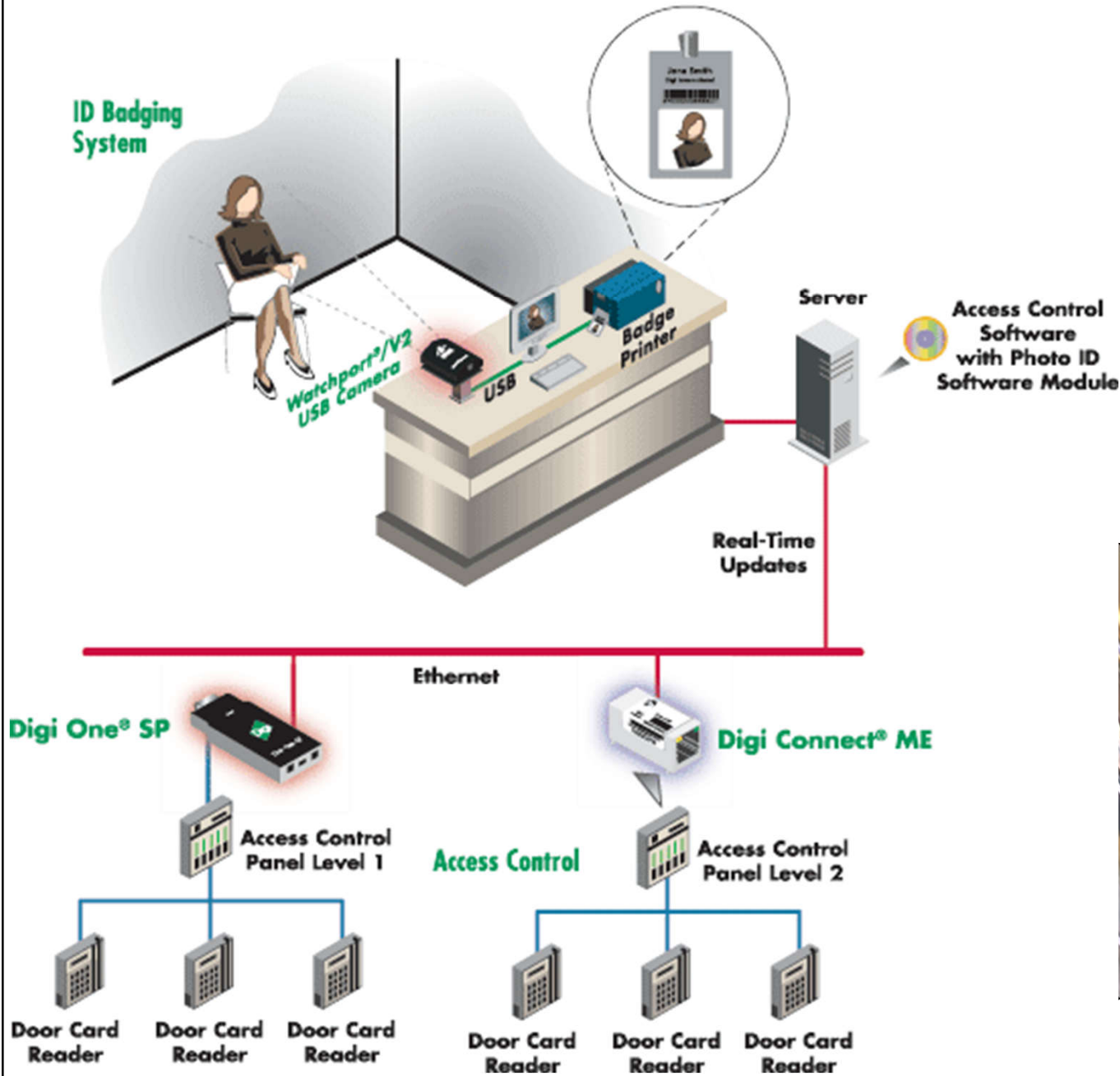

## Access control system



Pedestrian turnstiles

(Source: [www.digi.com](http://www.digi.com))

(Source: <http://www.baps.co.nz>)

# Car park control system

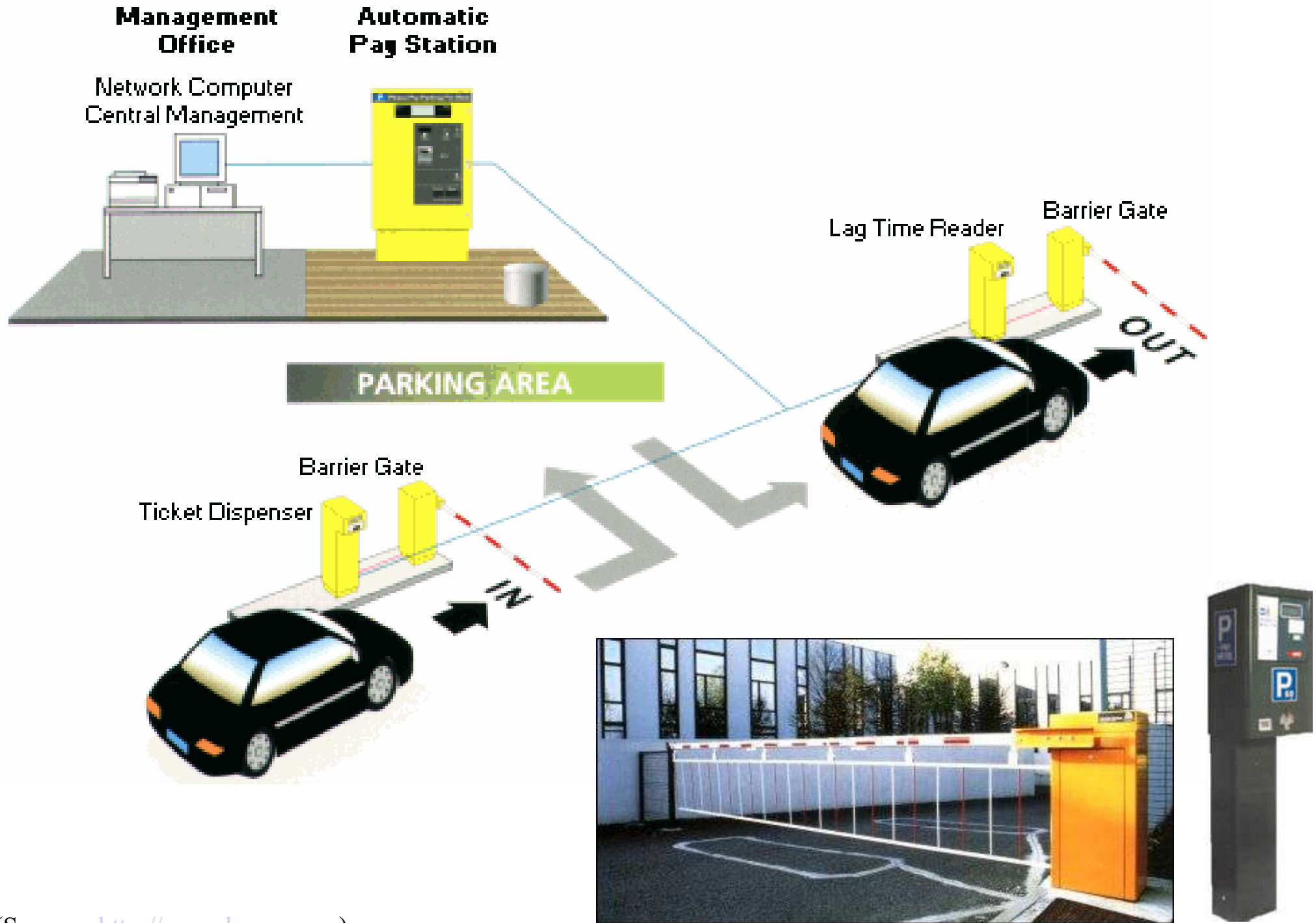

# Access control systems



- Access control system (ACS)
  - Control passage into or out of any area
  - Computer-based, electronic access control
  - Basic components:
    - Access cards & card readers
    - Access control keypads
    - Electric lock hardware
    - Access control field panels
    - Access control server computer
  - Latest trend: wireless & cloud-based systems





Examples of door access control systems (with door control readers, metal detectors, intercoms, IP cameras & emergency paging system)

## Door Control Systems

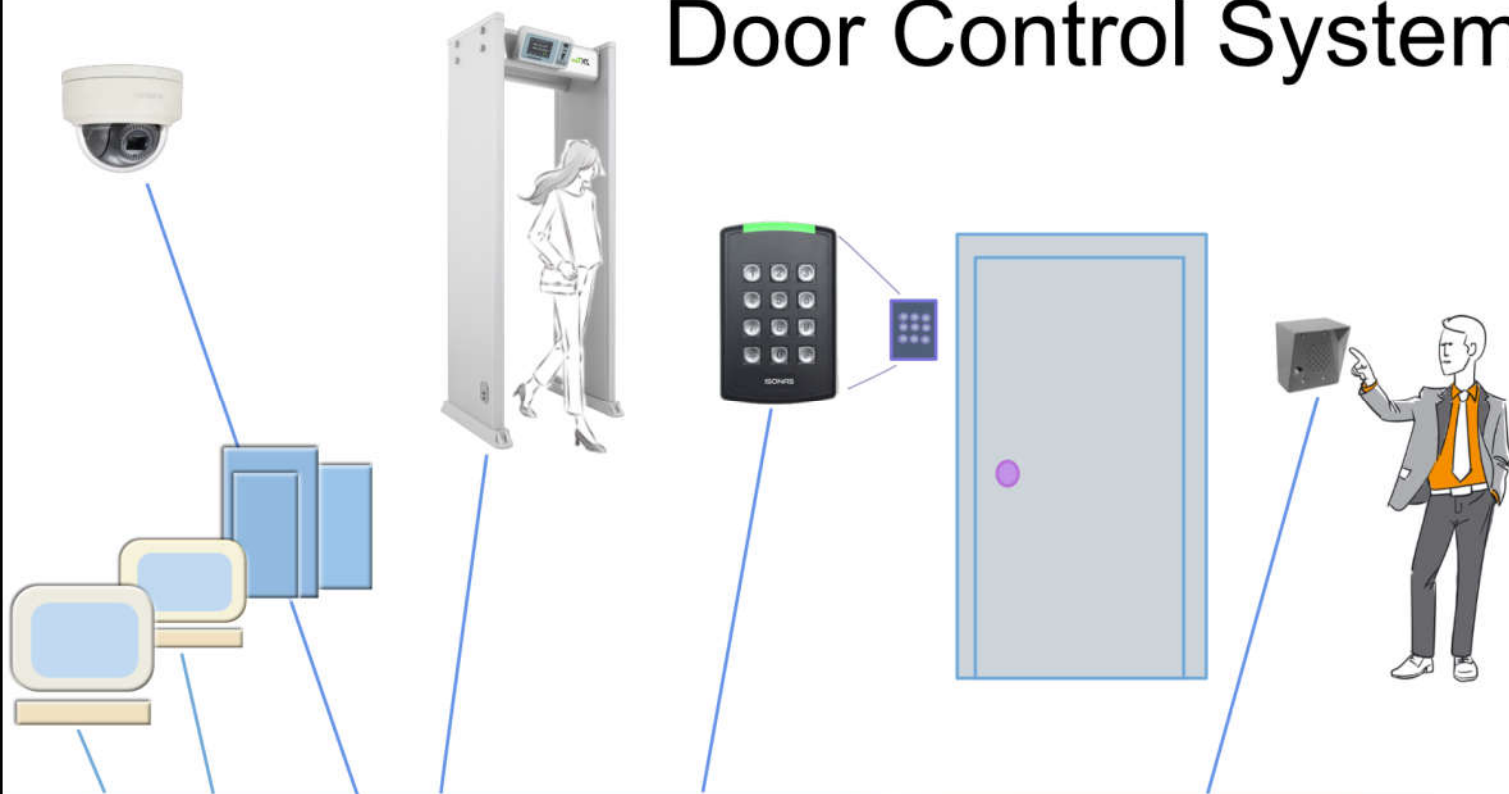

What are the key factors for door access control?



# Various levels of security for door access control systems

Level 1 Security – PIN Numbers	Lock with keypad Door Reader with keypad
Level 2 Security – Credentials	RFID IP Reader
Level 2.5 Credentials With Video	Intelligent IP Reader
Level 3 Security – Dual Authentication Systems	RFID IP Reader
Level 3.5 Dual Authentication Plus Video	Intelligent IP Reader with Keypad
Level 4 Security – Biometric Readers	Biometric IP Reader
Level 4.5 Biometric Readers Plus Video	

PIN = Personal identification numbers

RFID = Radio frequency identification

IP = Internet protocol

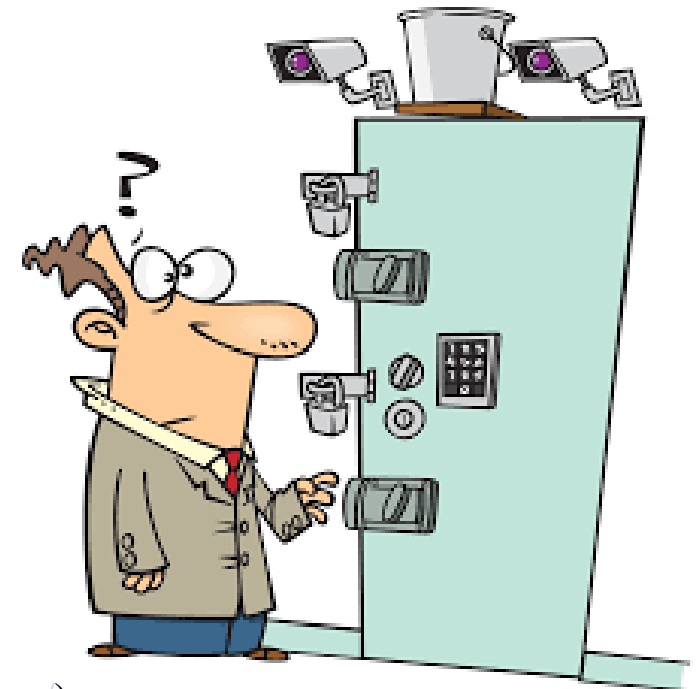

# Typical access control door wiring

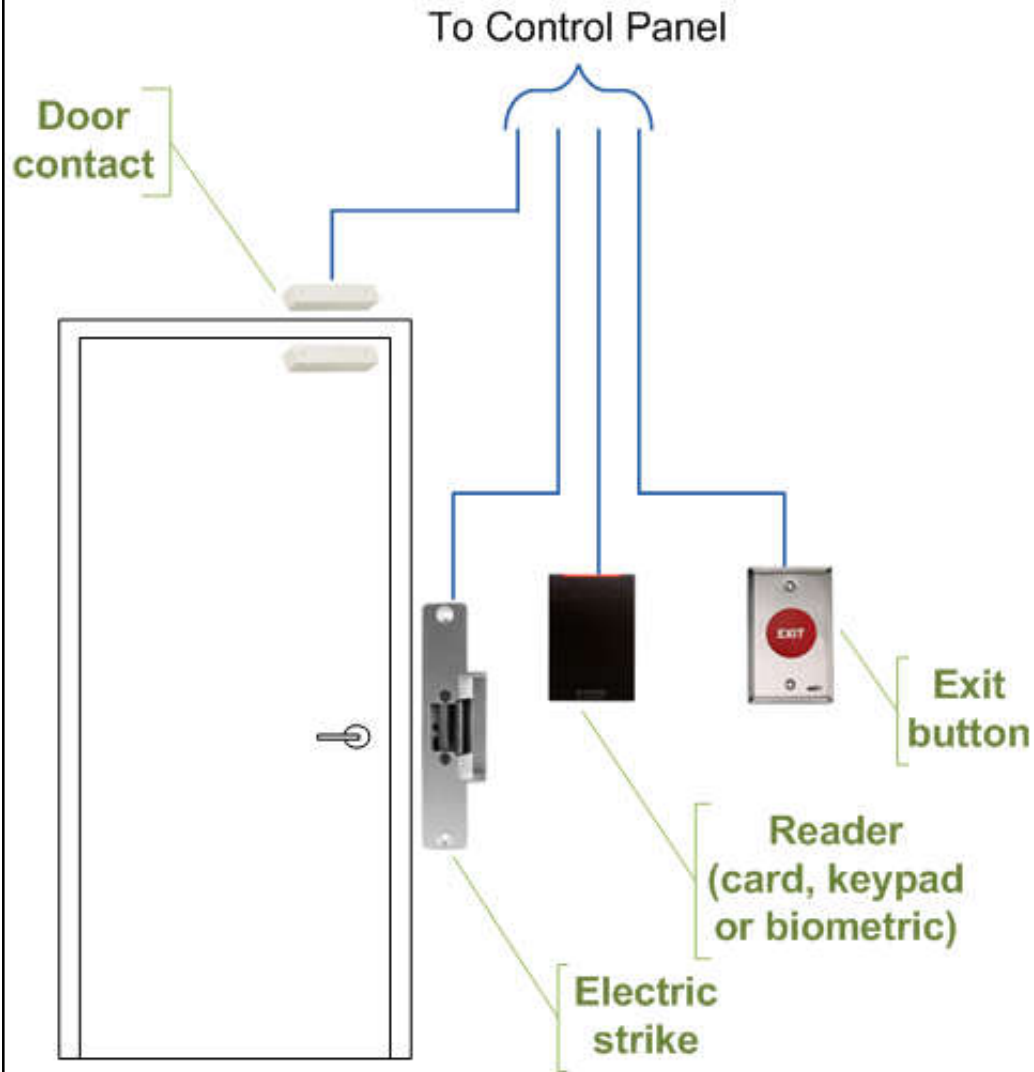

(a) With basic (non-intelligent) reader

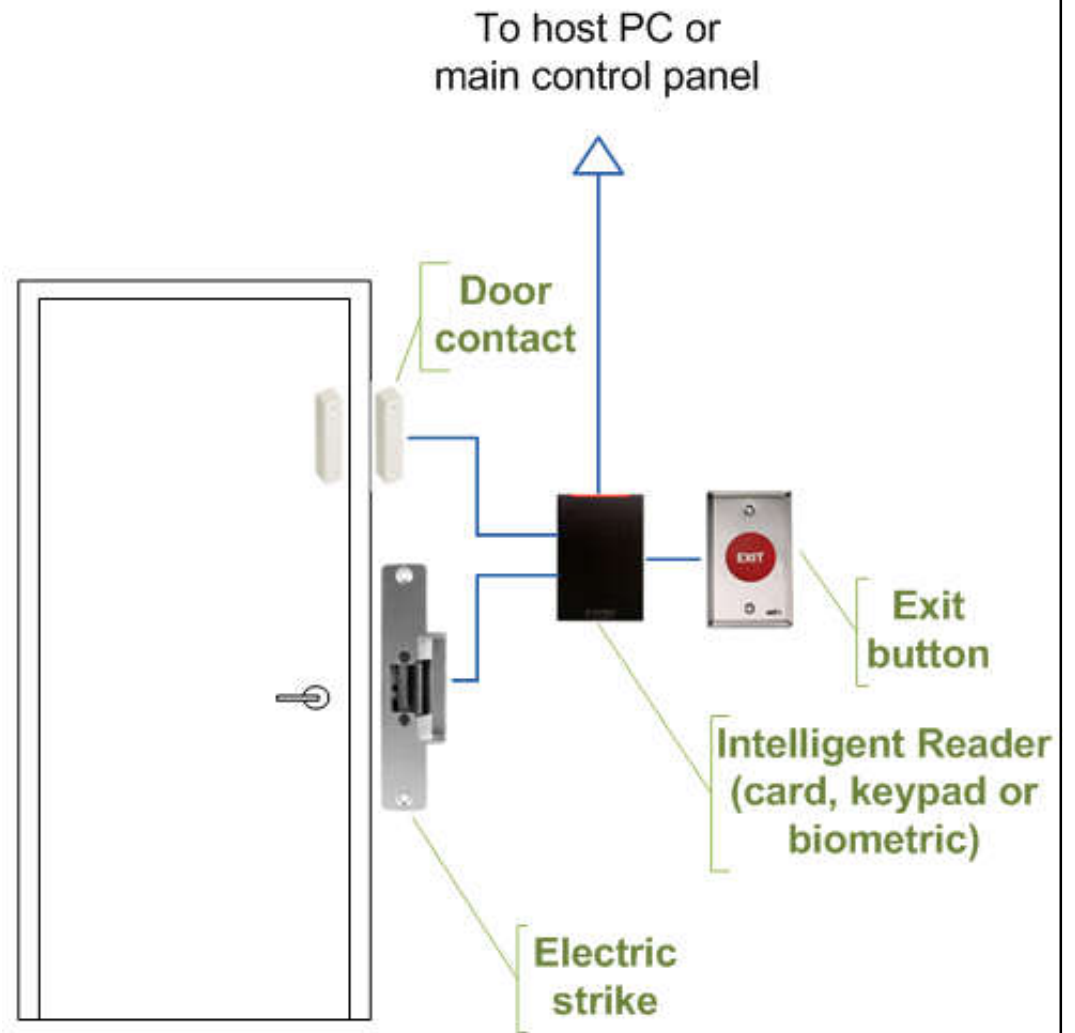

(b) With intelligent reader

# Access control system using IP controllers

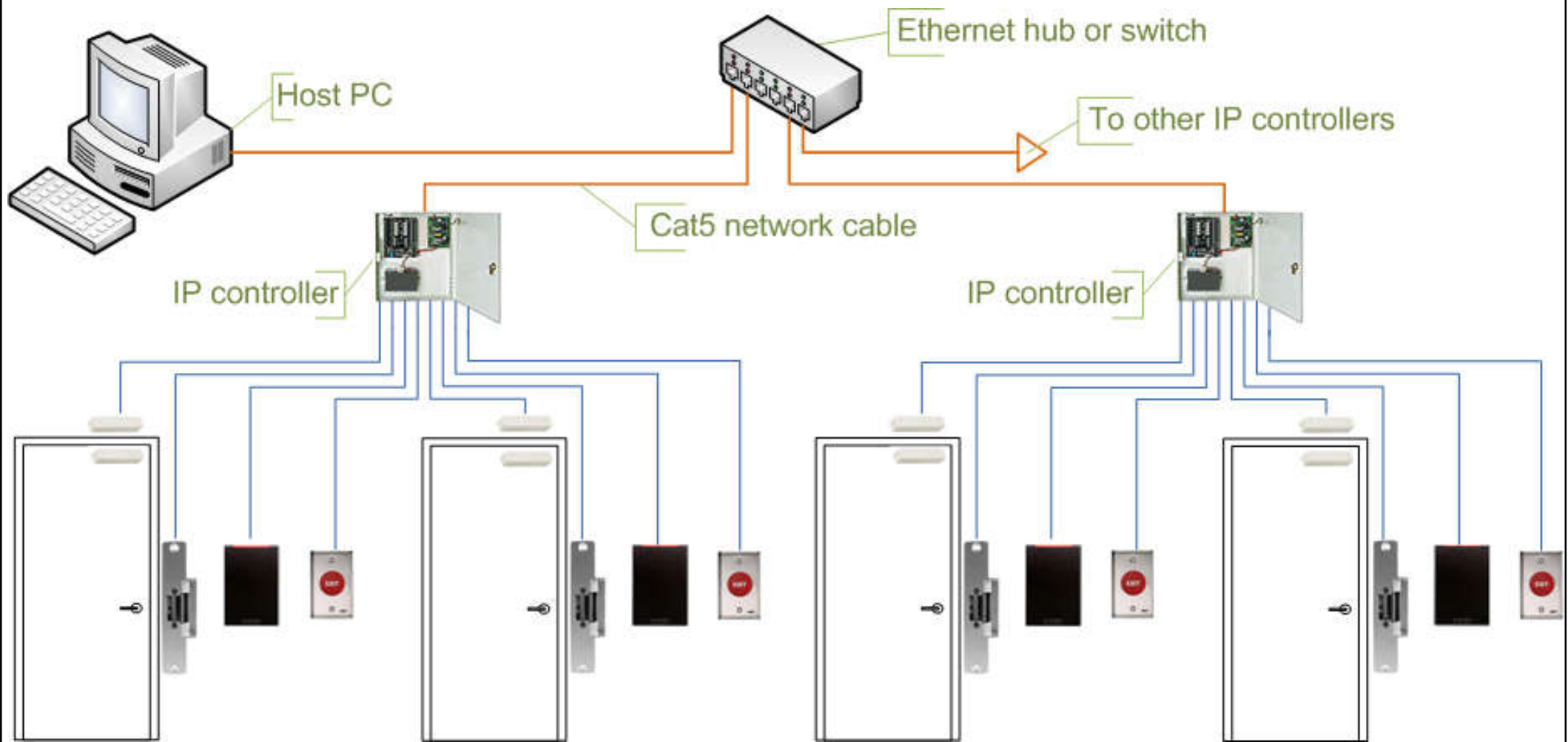

# How to integrate access control with fire alarm systems

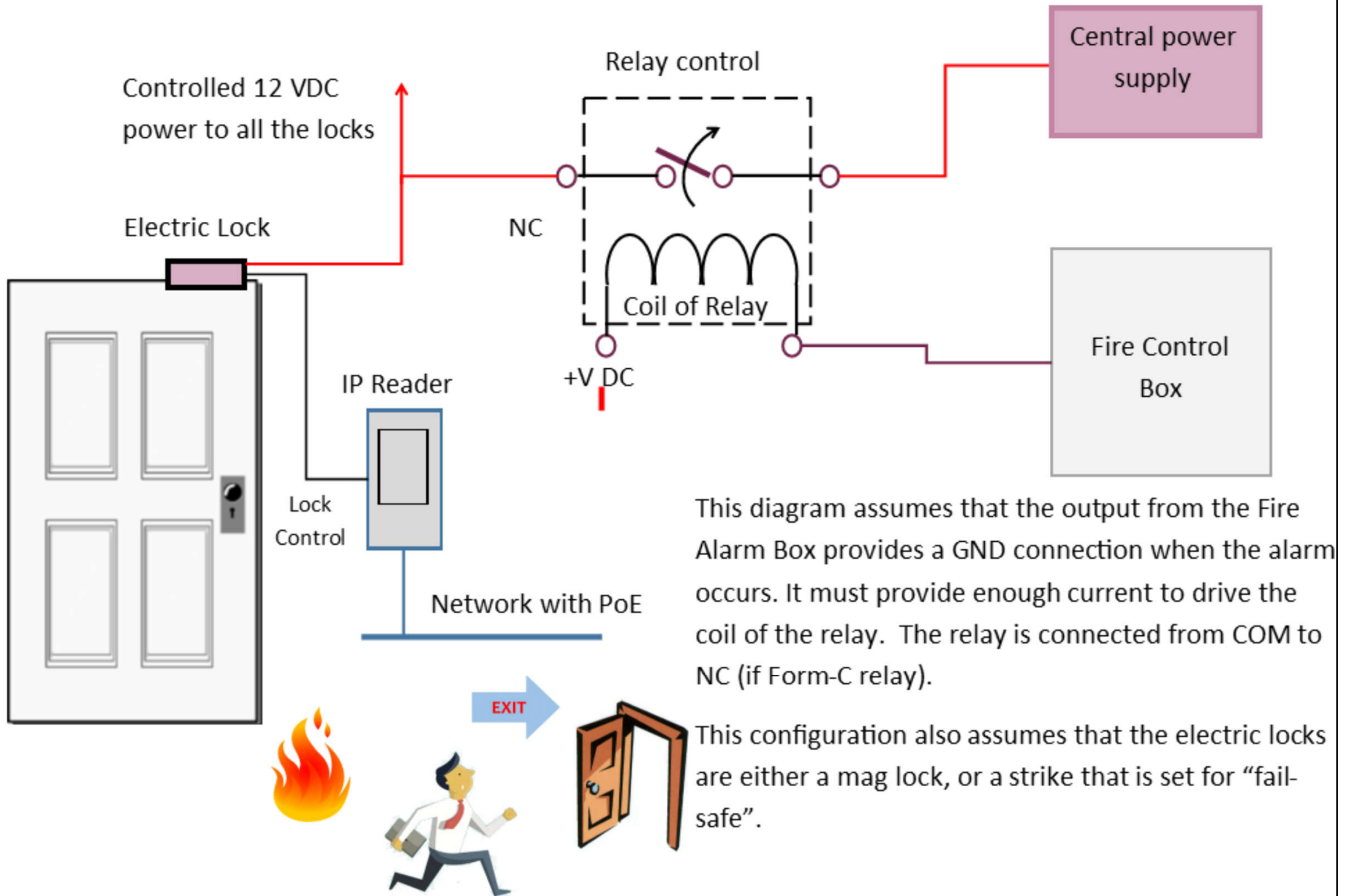

# Architecture of an access control system with network support

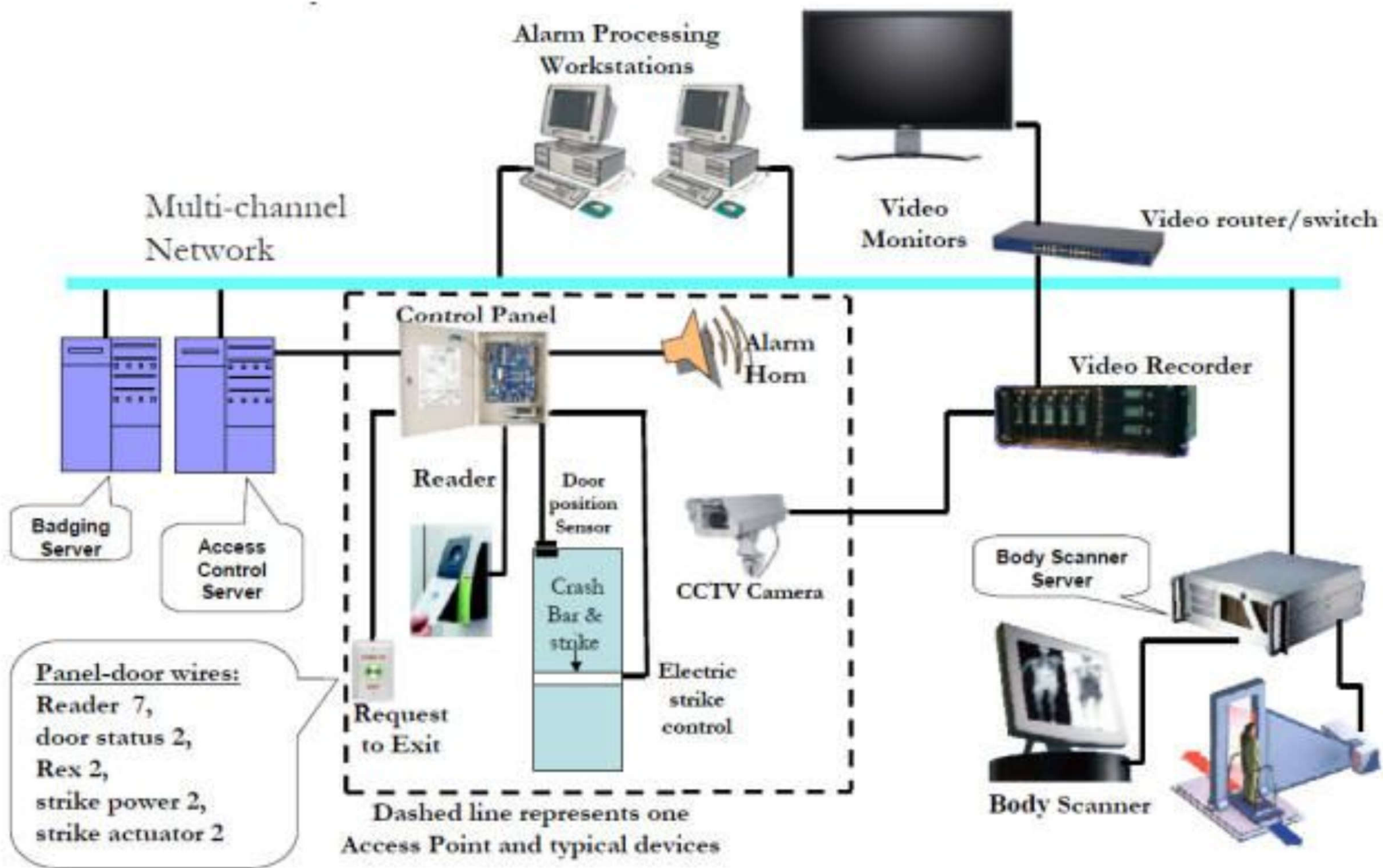

# Access control systems



- Integrate access control systems with BAS
  - Provide information regarding location of building occupants & how they move throughout a building
    - This can assist with energy efficiency, traffic flow management & occupant safety during emergency
  - Can be used to activate many BAS processes (e.g. turn on lights) when the staff enters the building
  - Make command & control actions work efficiently while ensuring the command is coming from the right credentials (to protect the assets)

# Access control systems



- Intercom systems

- Audio intercoms

- One to one connections (two-way audio)
- Many intercoms to a central control centre

- Video intercoms

- One intercom to one or many connections (e.g. smartphones & a central computer)
- Integrate with IP camera systems & door access control systems to provide a complete security system

- Visitor control systems (e.g. a delivery person)

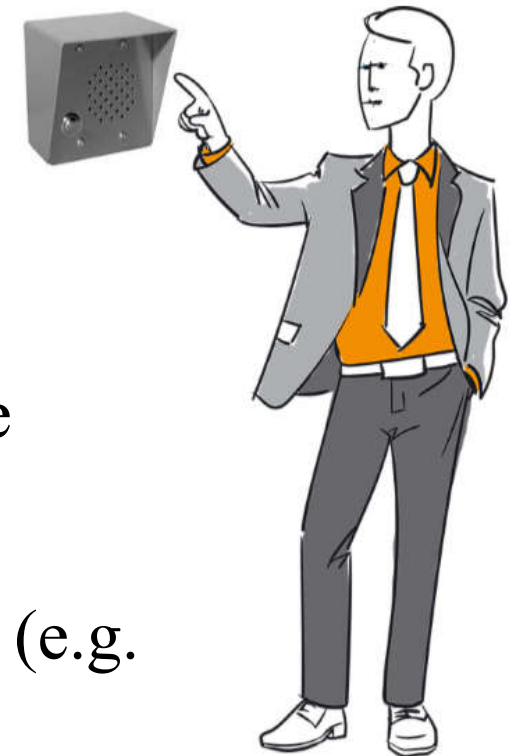



# Audio intercoms for door access control

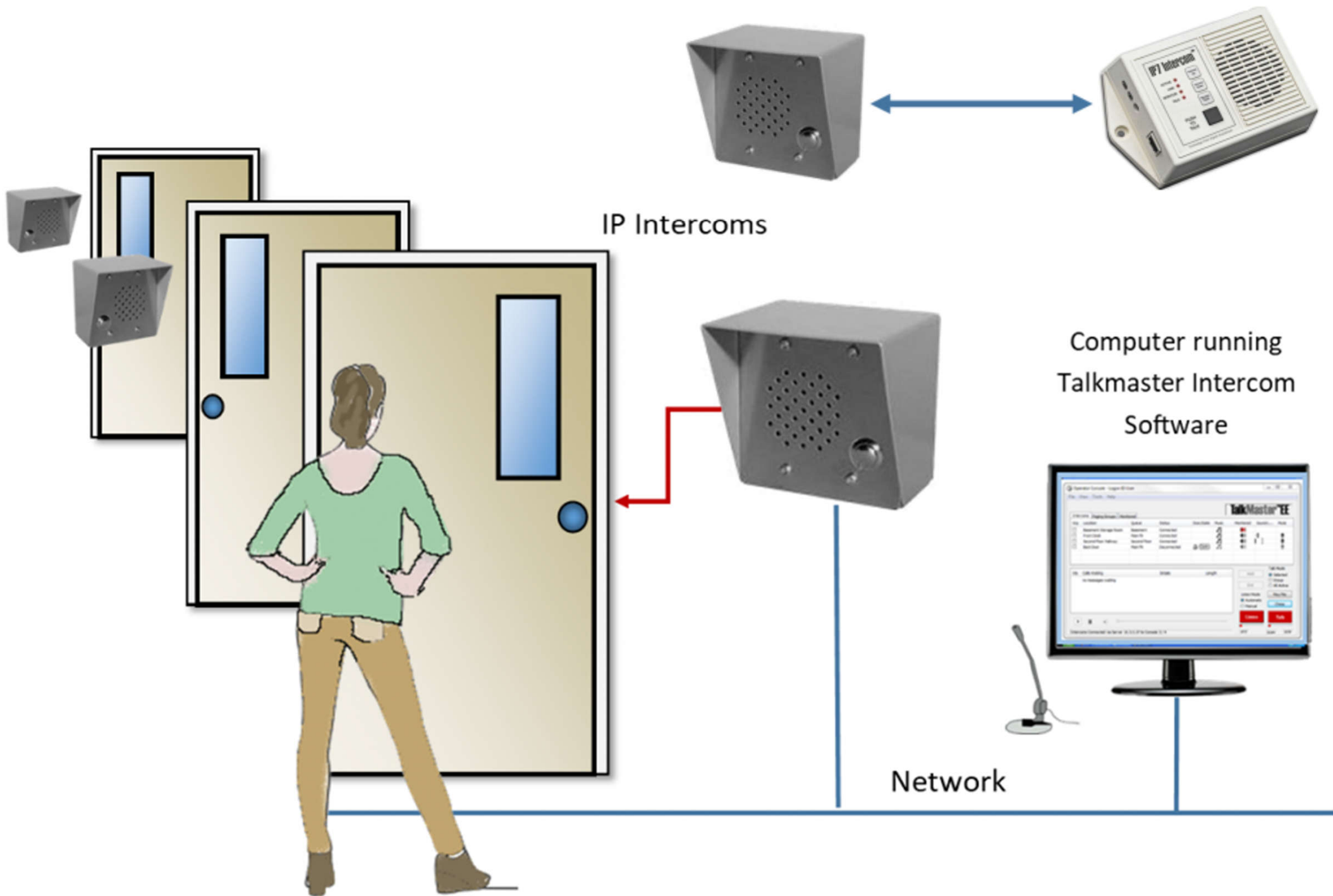

# Video intercoms & smartphone communication



(Source: <https://kintronics.com/ip-intercom-selection-and-comparison/>)

# Biometric & body temperature access control (check a person's temperature and check if they are wearing a mask)

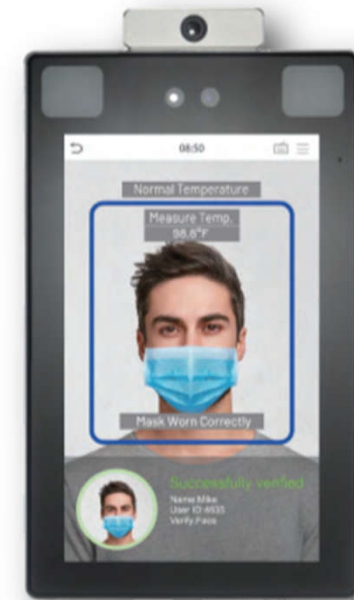
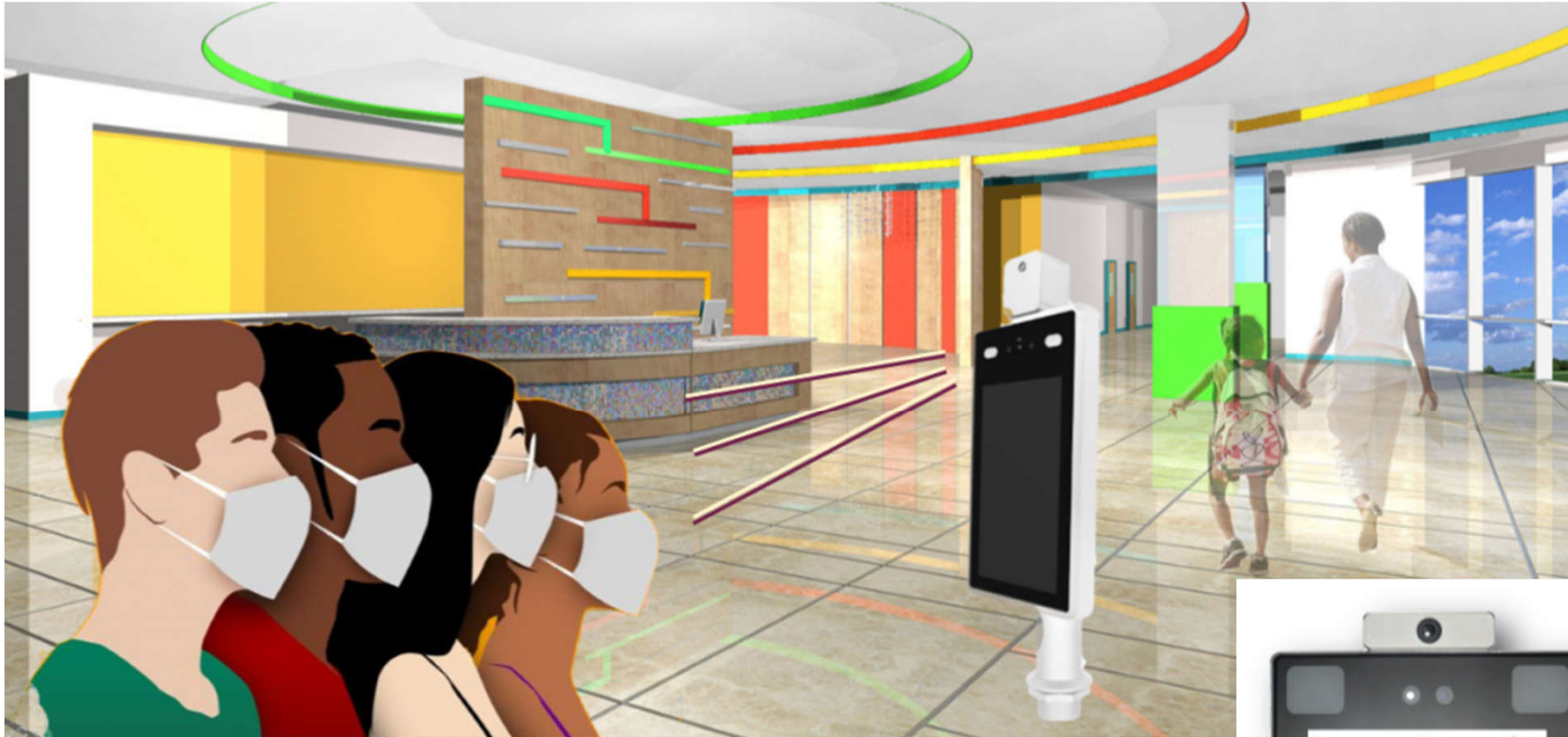

Video: Access Control with Temperature Monitoring (1:44) <https://youtu.be/w49T2gpbz8Q>

(Source: <https://kintronics.com/solutions/ip-door-access-control/comparison-of-face-recognition-and-temperature-access-control-panels/>)

# Burglar & intruder alarms



- Burglar alarm system include:

- Control panel
- Keypads
- Intruder detectors & motion detectors (e.g. passive infrared, microwave, or photoelectric)
- Door & window magnetic contacts
- Alarm bells or siren
- Central monitoring station/company (optional)



# Basic approach of an alarm system

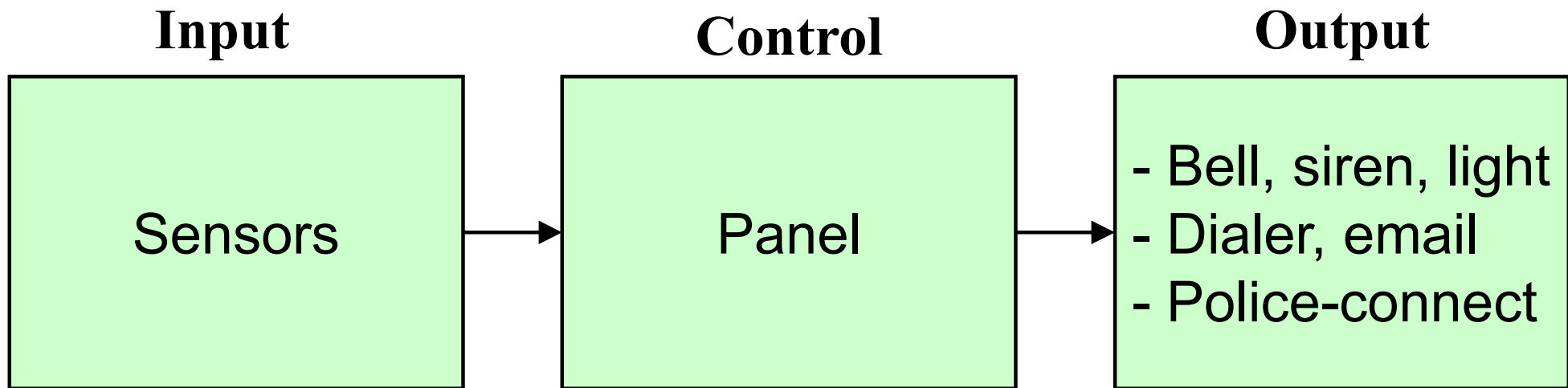

Detection sensors:

- Infrared
- Ultrasonic
- Microwave (Doppler effect)
- Dual technology
- Glass breaks, switches

Annunciation/  
alarm signaling





# Burglar & intruder alarms

- Intruder detection alarm system

- Mechanical contact switch
- Magnetic contact switch
- Glass-break & vibration detector
- Photo-electric sensors
- Motion sensors
  - e.g. passive infrared (PIR) sensors
- Signaling devices
  - Both audible & visual types

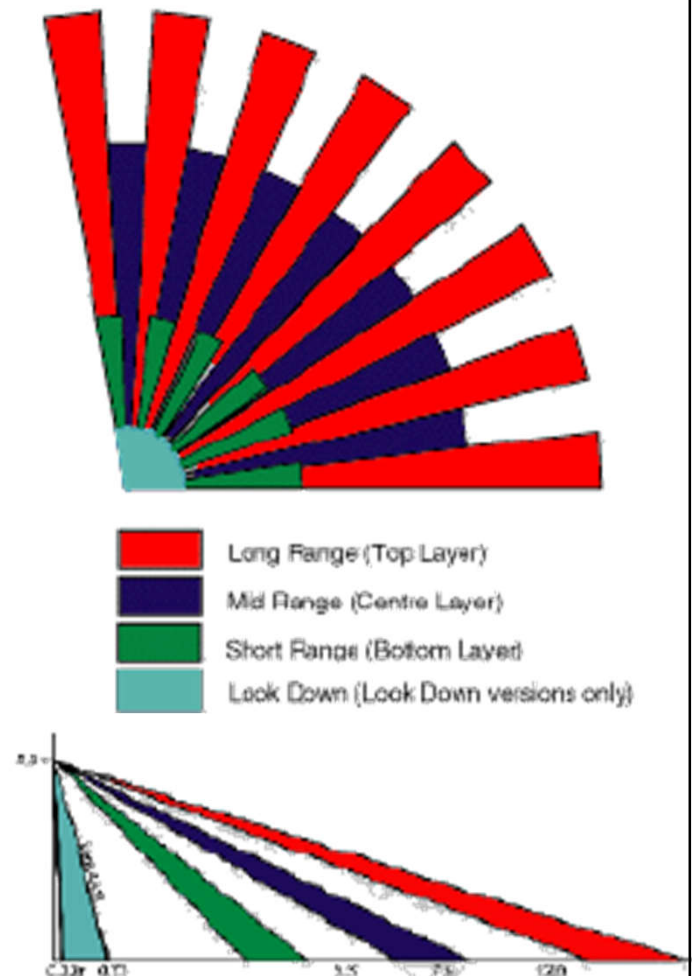

# Example of an intruder detection alarm system



# Components of intrusion detection alarm systems



- smoke detectors that detects smoke and sounds alarm to warn entire family.



-window/door contacts



-motion detectors



-Interior Siren







# Burglar & intruder alarms

- Additional items to the basic system
  - Smoke detectors
  - Glass break detectors
  - Panic buttons
  - Pressure mats
  - Closed circuit TV
  - Alarm screens
  - SMS alert service !! →

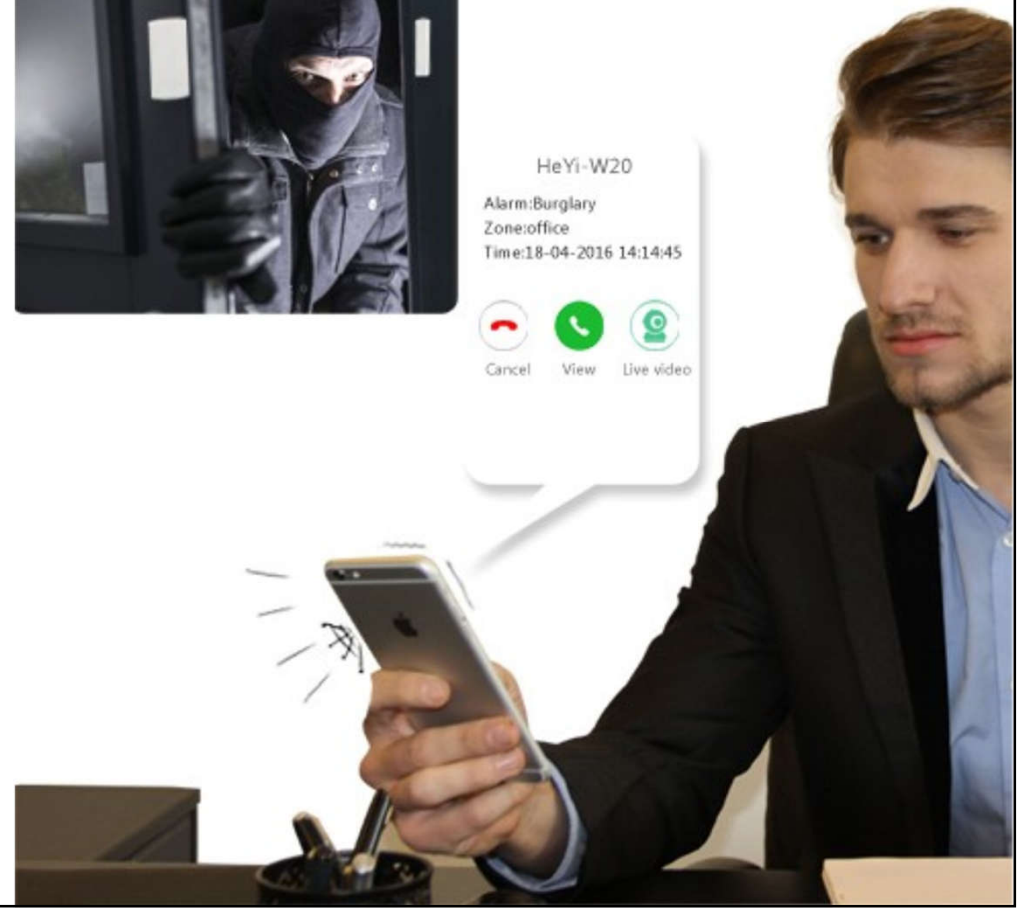
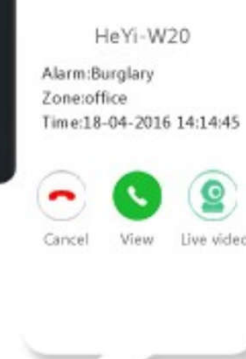



# Further reading

---

- CCTV - Designing Buildings Wiki  
<https://www.designingbuildings.co.uk/wiki/CCTV>
- Introduction to Access Control Systems  
<https://www.silvaconsultants.com/intro-to-access-control-systems>
- Introduction to Intrusion Alarm Systems  
<https://www.silvaconsultants.com/intro-to-intrusion-alarm-systems>
- Basic information on intruder alarm systems  
[https://www.dipolnet.com/basic\\_information\\_on\\_intruder\\_alarm\\_systems\\_bib770.htm](https://www.dipolnet.com/basic_information_on_intruder_alarm_systems_bib770.htm)